

39-15

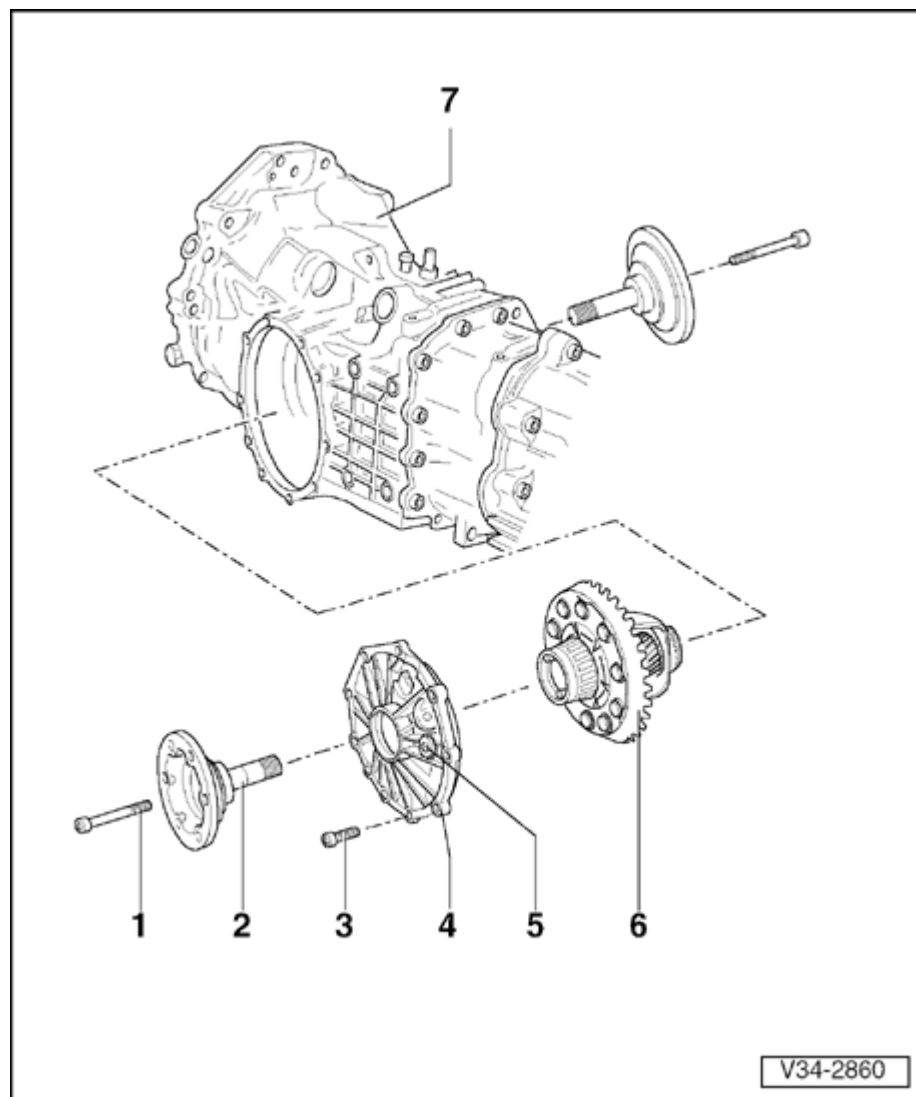

## Differential, removing and installing

### Note:

*Removing and installing is also possible with transmission installed in vehicle.*

**1 - Bolt, 10 Nm + 1/4 turn (90°) further**

**2 - Drive flange**

- ◆ When removing, secure with a drift to prevent it turning

**3 - Bolt, 25 Nm**

- ◆ Qty. 10

**4 - Cover for final drive**

- ◆ Removing and installing drive wheel for speedometer sender -G22 ⇒ [Page 39-4](#)
- ◆ If replaced: adjust ring gear ⇒ [Page 39-52](#)

V34-2860

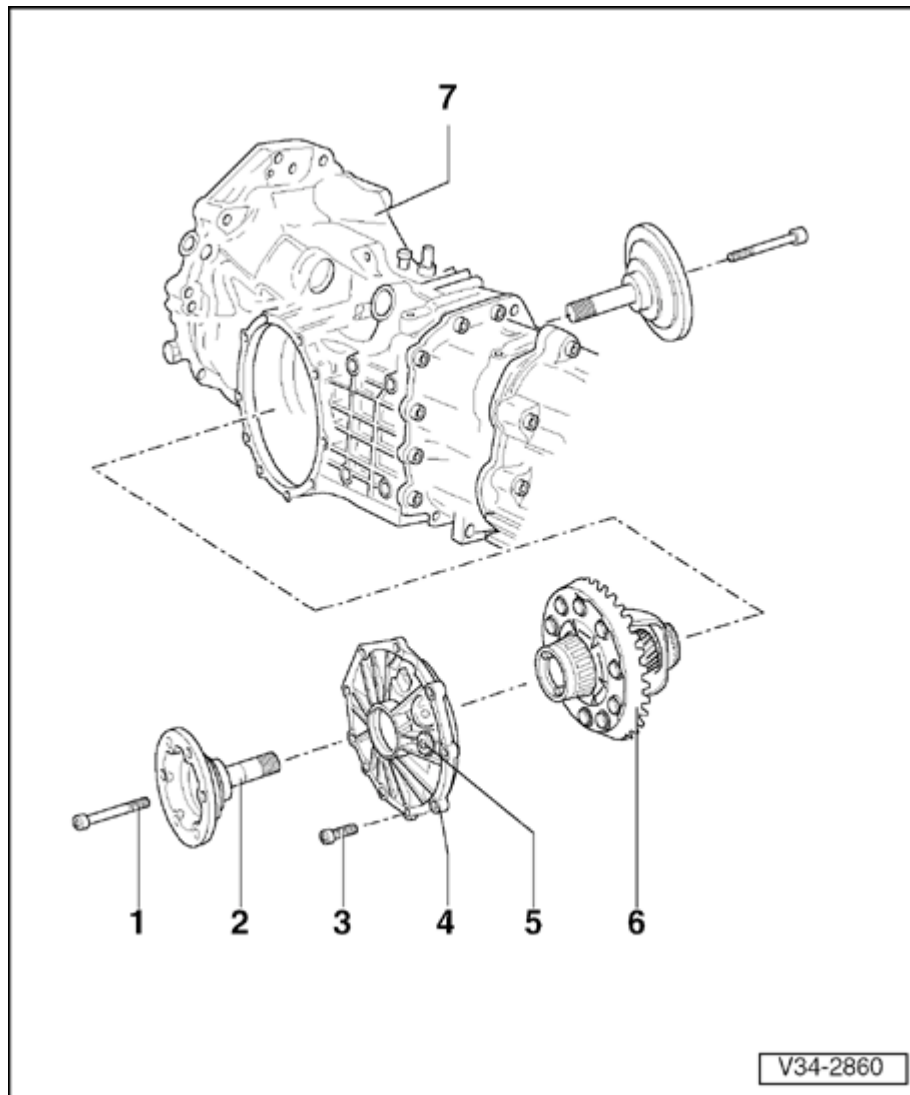

### 5 - Oil filler plug, 40 Nm

- ◆ Checking oil level in transmission ⇒ [Page 34-39](#)

### 6 - Differential

- ◆ Disassembling and assembling ⇒ [Page 39-17](#)
- ◆ If replaced: adjust ring gear ⇒ [Page 39-52](#)

### 7 - Transmission housing

- ◆ Servicing ⇒ [Page 34-127](#)