

Transmission, disassembling and assembling

Note:

Disassembly sequence ⇒ [Page 34-49](#) .

Transmission overview

- 1 - 1st gear
- 2 - 2nd gear
- 3 - 3rd gear
- 4 - 4th gear
- 5 - 5th gear
- 6 - Reverse gear
 - ◆ Removing and installing reverse idler gear
⇒ [Page 35-44](#)
- 7 - Transmission housing
- 8 - Transmission cover

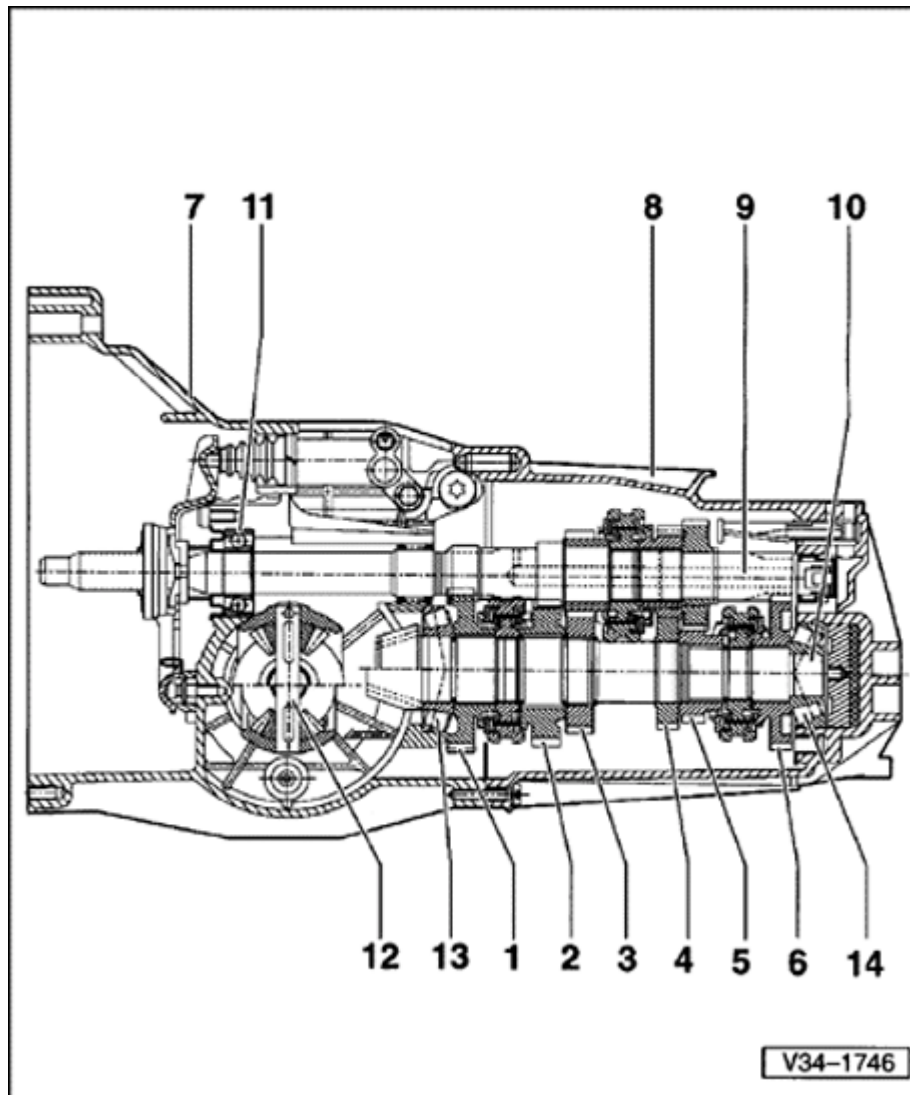

9 - Input shaft

- ◆ Disassembling and assembling ⇒ [Page 35-1](#)

10 - Pinion shaft

- ◆ Disassembling and assembling ⇒ [Page 35-21](#)

11 - Ball bearing

- ◆ Adjusting ⇒ [Page 35-17](#) , Input shaft, adjusting

12 - Differential

- ◆ Removing and installing ⇒ [Page 39-10](#)
- ◆ Disassembling and assembling ⇒ [Page 39-15](#)

13 - Tapered roller bearing

- ◆ Adjusting ⇒ [Page 39-35](#)

14 - Tapered roller bearing

- ◆ Adjusting ⇒ [Page 39-35](#)

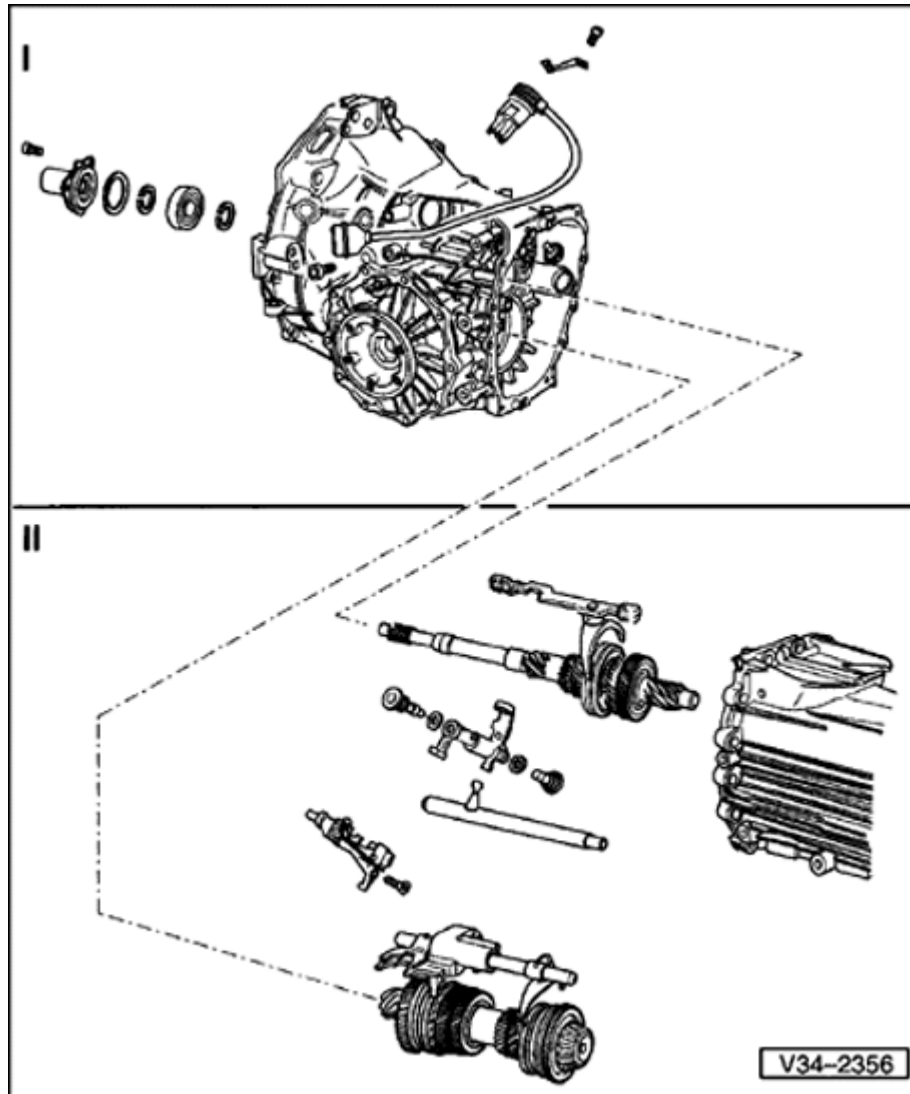

Assembly overview

- I - Input shaft ball bearing and multi-function switch, removing and installing ⇒ [Page 34-41](#)
- II - Input shaft, pinion shaft, selector rods and transmission cover, removing and installing ⇒ [Page 34-45](#)

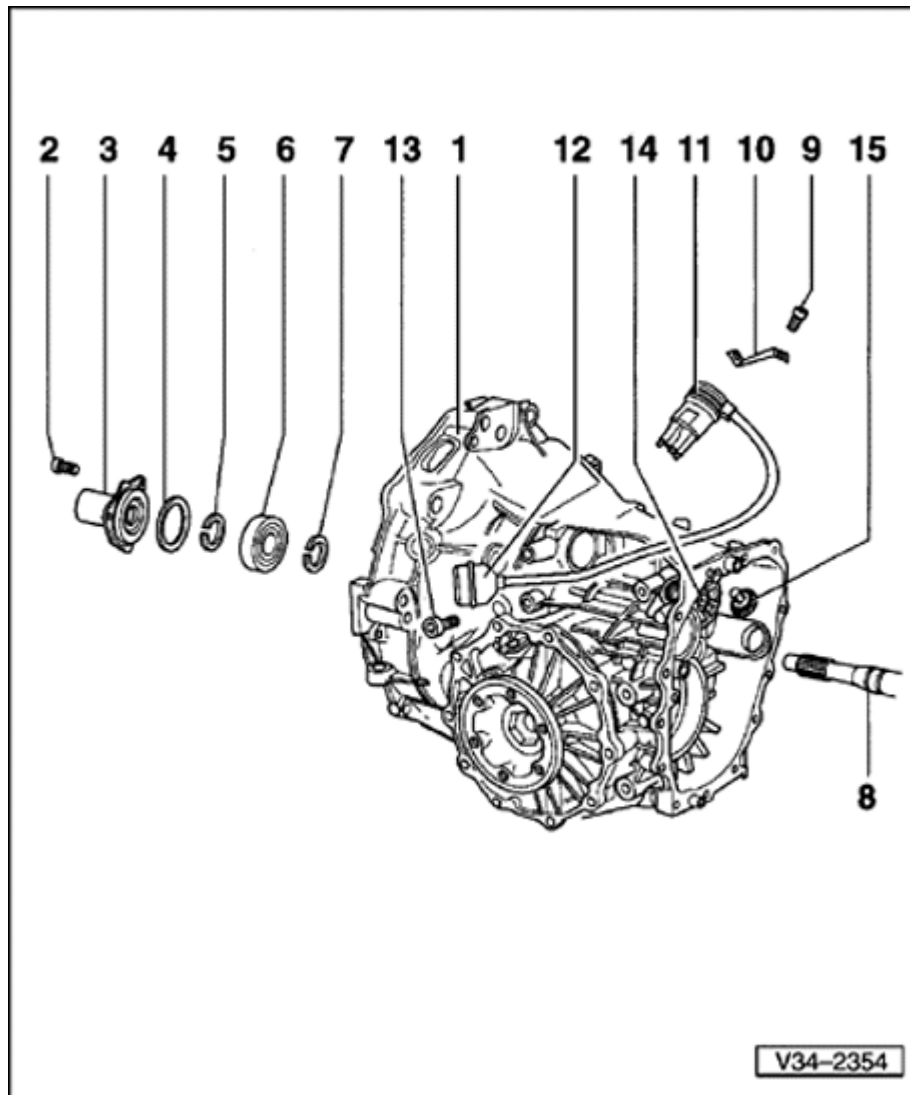

Input shaft ball bearing and multi-function switch, removing and installing

1 - Transmission housing

- ◆ With differential and flange shafts
- ◆ Removing and installing flange shafts ⇒ [Page 39-1](#)
- ◆ Removing and installing differential ⇒ [Page 39-10](#)
- ◆ Removing and installing speedometer Vehicle Speed Sensor (VSS) ⇒ [Page 39-7](#)
- ◆ Removing and installing speedometer drive gear ⇒ [Page 39-7](#)
- ◆ Breather installation position ⇒ Fig. 1

2 - Torx[®] bolt

- ◆ Always replace
- ◆ 35 Nm (26 ft lb)
- ◆ Self-locking

3 - Guide sleeve

- ◆ Installed with O-ring and seal for input shaft ⇒ [Page 30-17](#)

4 - Dished washer

- ◆ Smaller diameter (convex side) faces guide

sleeve

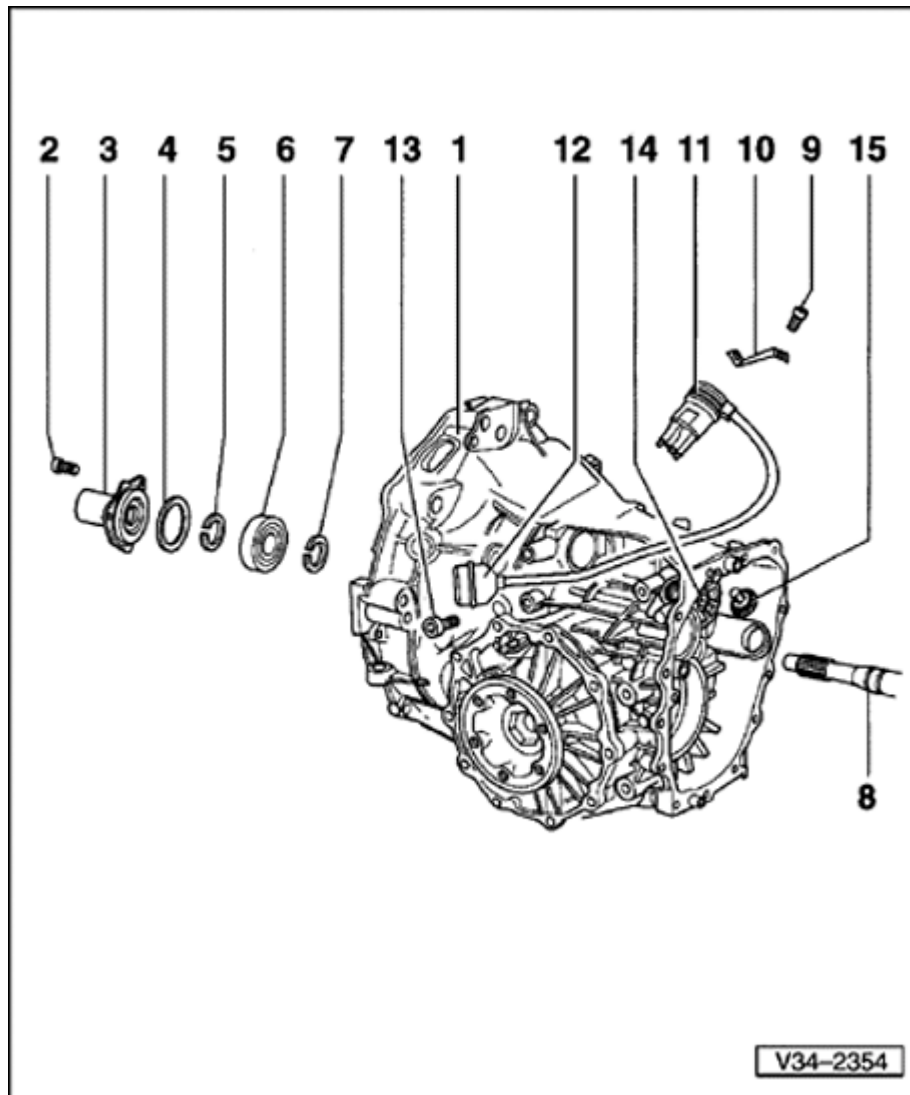

5 - Circlip

- ◆ Determining thickness and input shaft, adjusting ⇒ [Page 35-17](#)

6 - Input shaft ball bearing

- ◆ Removing and installing ⇒ [Page 34-49](#)

7 - Circlip

- ◆ Determining thickness and input shaft, adjusting ⇒ [Page 35-17](#)

8 - Input shaft

- ◆ Removing and installing ⇒ [Page 34-45](#)
- ◆ Disassembling and assembling ⇒ [Page 35-1](#)
- ◆ Adjusting ⇒ [Page 35-17](#)
- ◆ Servicing input shaft ball bearing ⇒ [Page 35-1](#)

9 - Socket-head bolt

- ◆ 25 Nm (18 ft lb)

10 - Locking plate

- ◆ For multi-function switch

11 - Multi-function switch

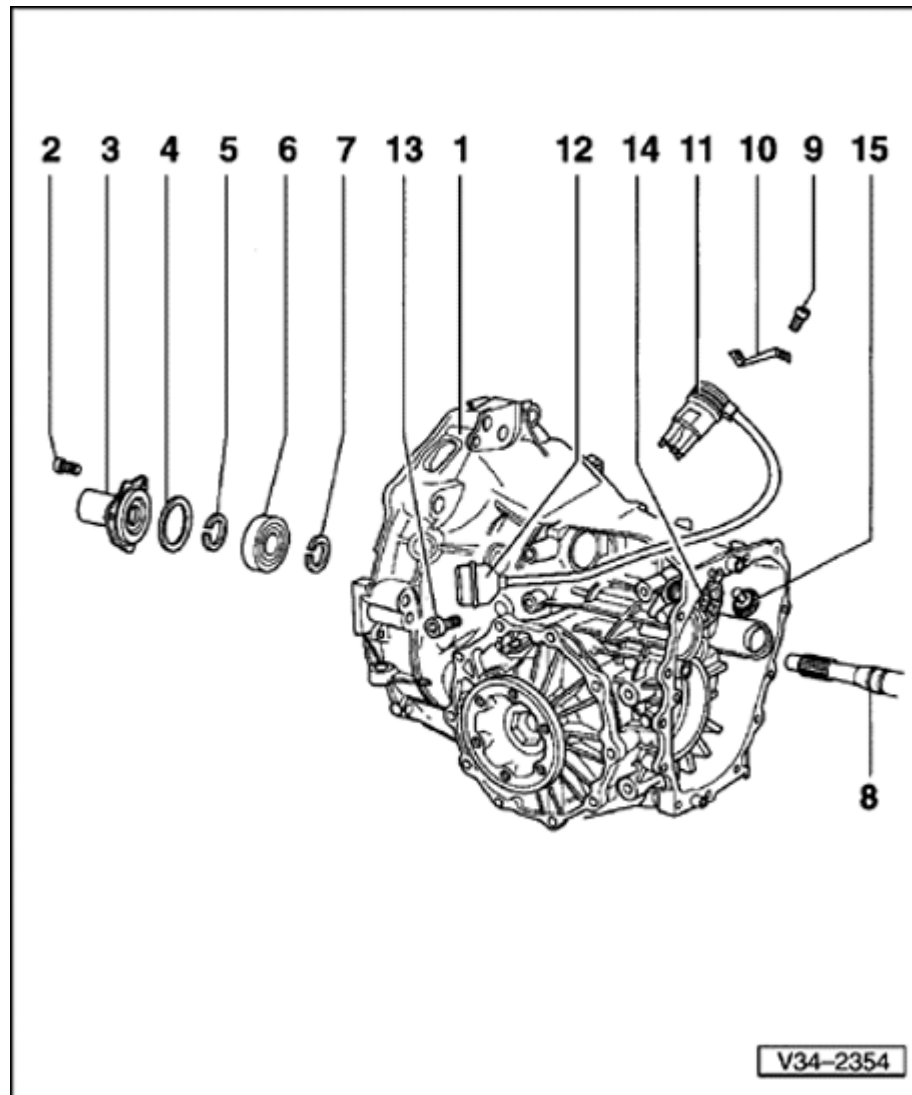

12 - Multi-function switch harness connector

13 - Socket-head bolt

◆ 10 Nm (7 ft lb)

14 - Cover for shift rod

◆ Removing and installing ⇒ [Page 34-62](#)

15 - Gear lock for 5th and reverse gear

◆ Removing and installing ⇒ [Page 34-69](#)

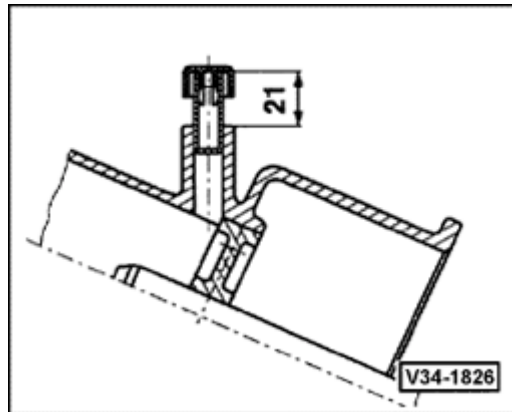

A

Fig. 1 Breather installation position

After pressing in, the breather must project 21 mm (0.83 in.) out of the housing.

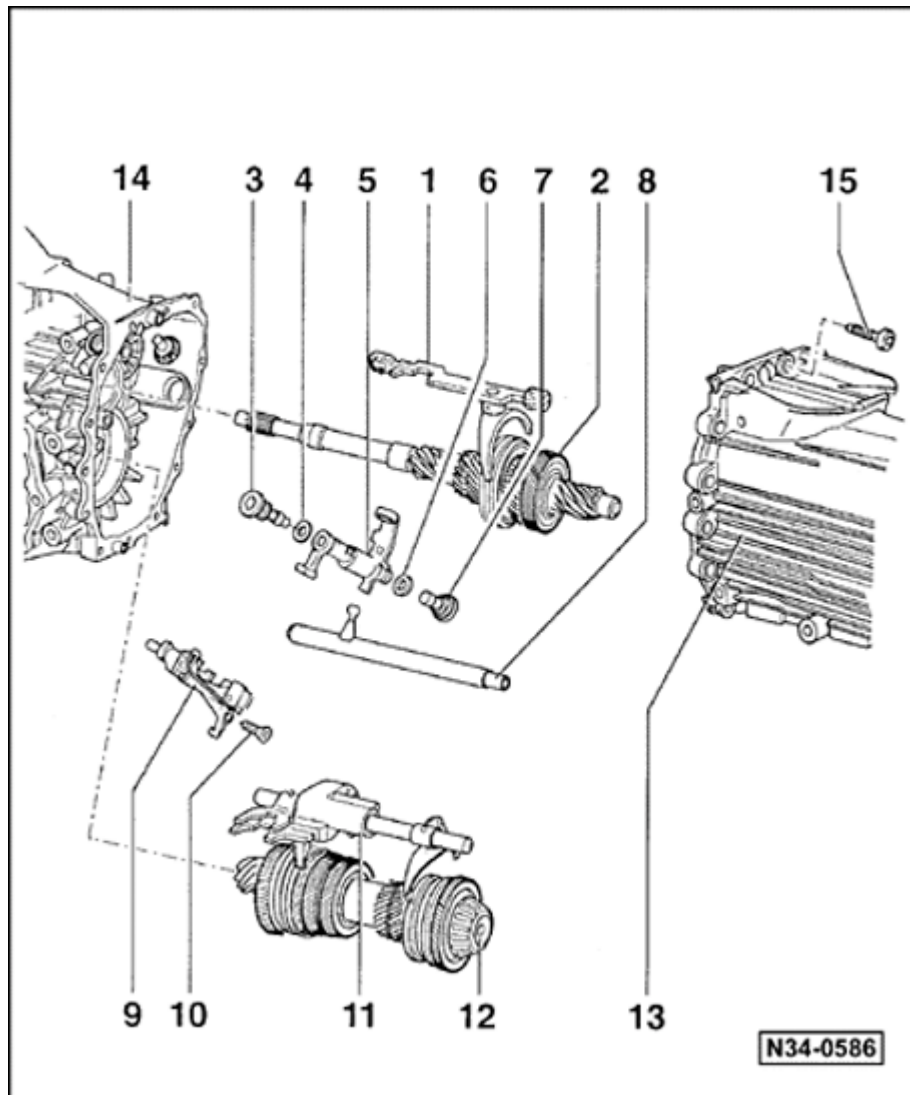

Input shaft, pinion shaft, selector rods and transmission cover, removing and installing

1 - Shift rod with shift fork for 3rd and 4th gear

- ◆ Disassembling and assembling ⇒ [Page 34-62](#)
- ◆ Replacing bushings ⇒ [Page 34-62](#)

2 - Input shaft

- ◆ Disassembling and assembling ⇒ [Page 35-1](#)
- ◆ Adjusting ⇒ [Page 35-17](#)
- ◆ Servicing input shaft ball bearing ⇒ [Page 35-17](#)

3 - Left stop bolt

- ◆ 40 Nm (30 ft lb)

4 - Washer

5 - Relay shaft

- ◆ Installation position ⇒ [Page 34-62](#)

6 - Washer

7 - Right stop bolt

- ◆ 40 Nm (30 ft lb)

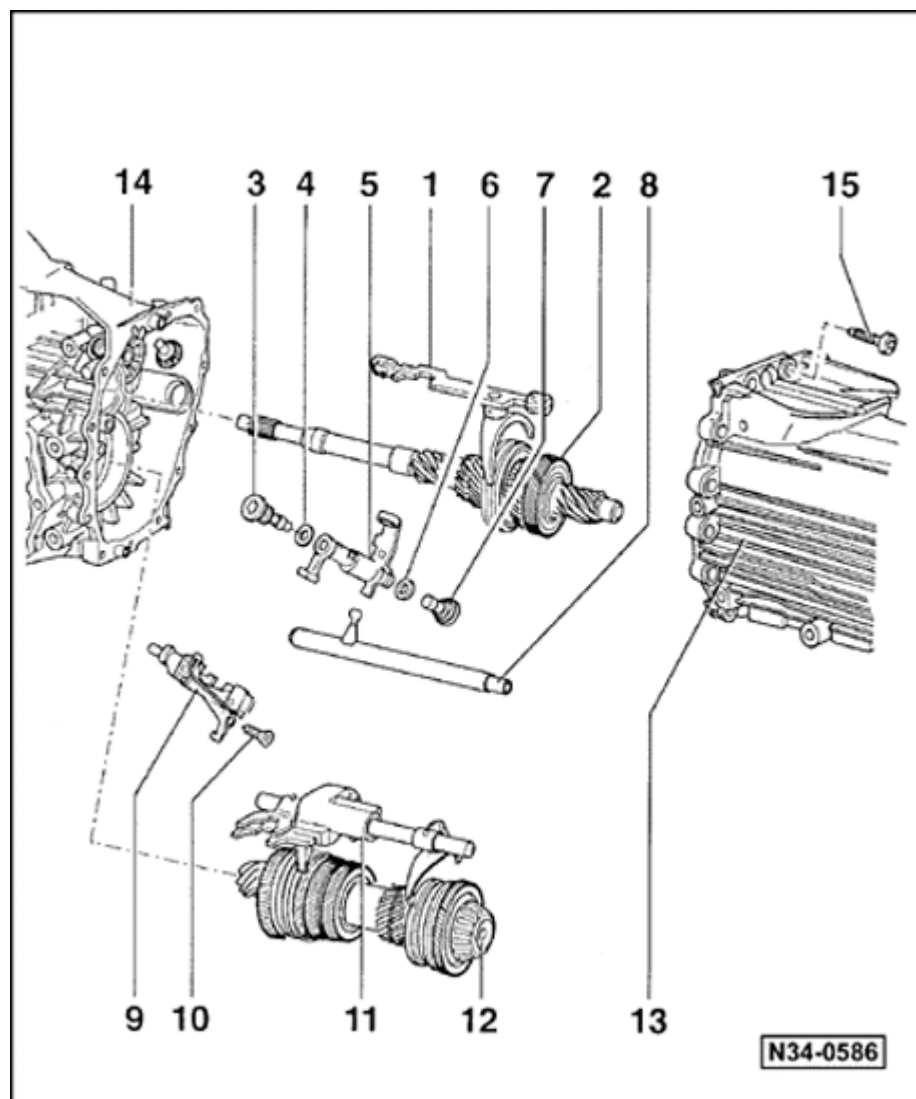

8 - Shift rod

- ◆ Installation position ⇒ [Page 34-62](#)
- ◆ Replacing shift rod sealing washer ⇒ [Page 34-62](#)

9 - Shift detent

- ◆ Installation position ⇒ [Page 34-62](#)

10 - Torx[®] bolt

- ◆ 25 Nm (18 ft lb)
- ◆ With shoulder to secure shift detent spring

11 - Shift rod with shift fork for 1st/2nd/5th and reverse gear

- ◆ Disassembling and assembling ⇒ [Page 34-62](#)
- ◆ Removing and installing ball sleeve ⇒ [Page 34-66](#) , ⇒ [Fig. 2](#)

12 - Pinion shaft

- ◆ Disassembling and assembling ⇒ [Page 35-21](#)
- ◆ Adjusting ⇒ [Page 39-35](#)
- ◆ Servicing pinion shaft ball bearing ⇒ [Page 35-21](#)

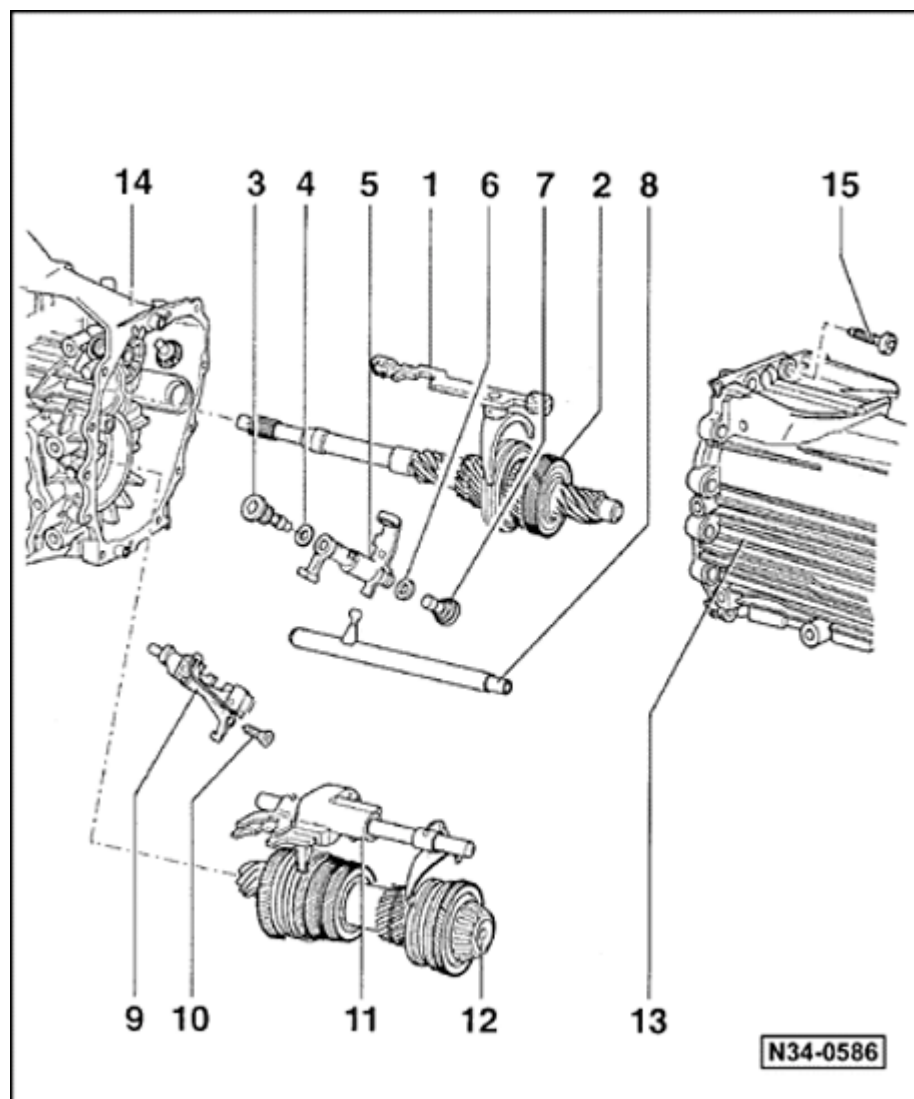

13 - Transmission cover

- ◆ Coat sealing surfaces with thin layer of sealant AMV 188 001 02
- ◆ Removing and installing oil collector tray ⇒ [Page 34-48](#) , ⇒ [Fig. 1](#)

14 - Transmission housing

- ◆ Match components according to transmission code letters found in parts catalog microfiche

15 - Torx® bolt

- ◆ 22 Nm (16 ft lb)

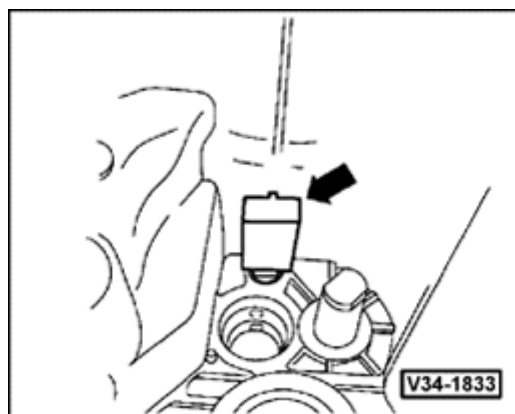

A **Fig. 1** Removing and installing oil collector tray

Removing

- Turn oil collector tray (arrow) and pull out.

Installing

- Push oil collector tray into transmission, until it snaps in.

Installation position: oil collector tray faces upward in transmission cover.

Input shaft ball bearing, multi-function switch, input shaft, pinion shaft, shift rods and transmission cover, removing and installing

Notes:

- ◆ *To remove the above-mentioned components, it is not necessary to remove the differential.*
- ◆ *Removal is only necessary when adjustments have to be performed ⇒ [Page 39-33](#) , list of adjustments*

Special tools and equipment

- ◆ VW309 holding plate
- ◆ VW353 transmission support
- ◆ 3235 press device
- ◆ VAG1306 drip tray
- ◆ VAG1582 taper roller bearing puller
- ◆ VAG1582/2 gripping piece

◆ AMV 188 001 02 sealant

Removing

- Place VAG1306 drip tray under transmission.
- Drain transmission oil.
- Secure transmission to assembly stand ⇒ [Page 34-29](#) .

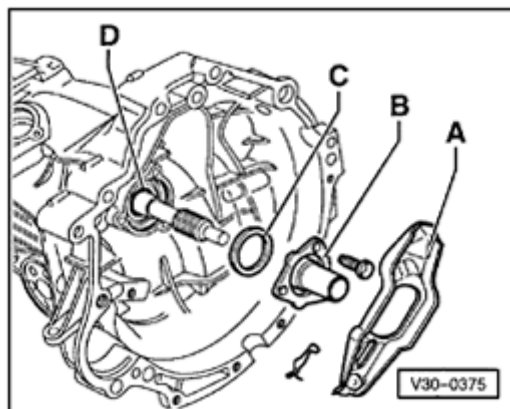

A

- Remove clutch release lever -A- with release bearing.

Notes:

- ◆ *Before removing the guide sleeve, slide a shrink tube over the input shaft splines to protect the seal.*
- ◆ *Remove the seal in the guide sleeve ⇒ [Page 30-18](#) .*
- Remove guide sleeve -B-.
- Remove spring washer -C-.
- Remove circlip -D- in front of input shaft ball bearing.
- Note thickness of circlip, if ball bearing, input shaft or transmission housing is not replaced.

34-51

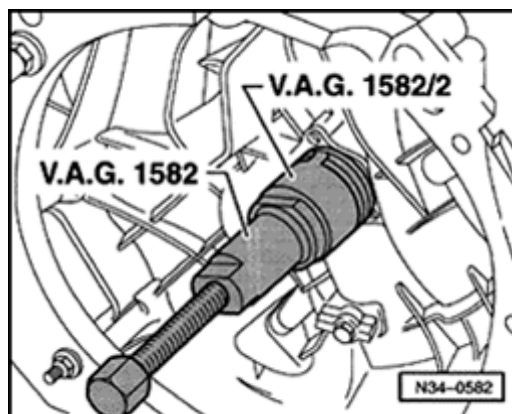

- A**
- Pull input shaft ball bearing out of transmission housing.

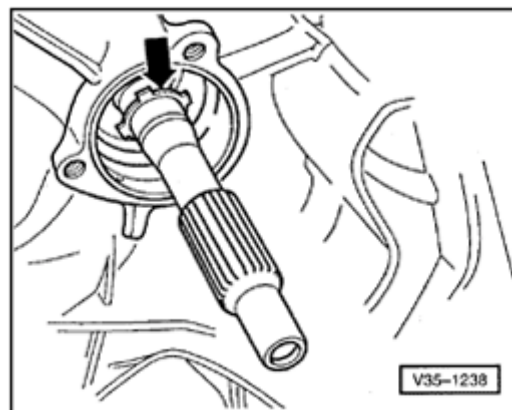

- A**
- Remove circlip (arrow) behind input shaft ball bearing.
 - Note thickness of circlip, if ball bearing, input shaft or transmission housing is not replaced.

34-52

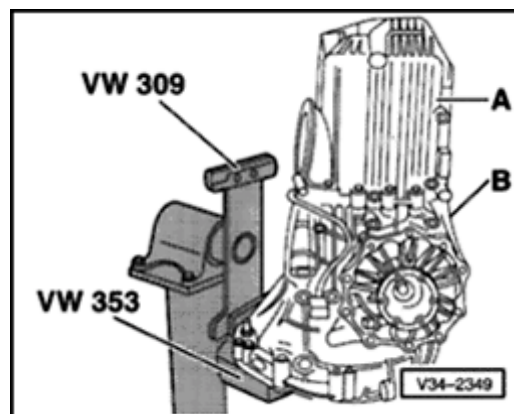

- A
- Remove transmission cover -A- from transmission housing -B-.

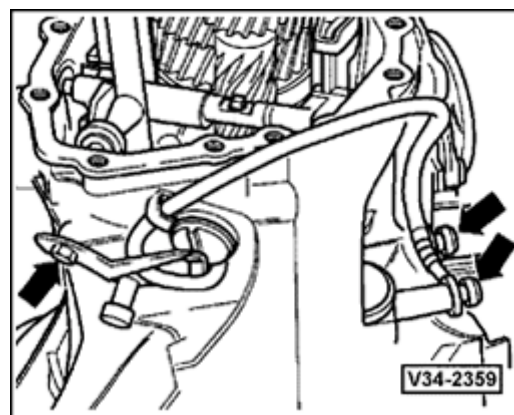

- A
- Remove bolts (arrows) and pull out multi-function switch.

34-53

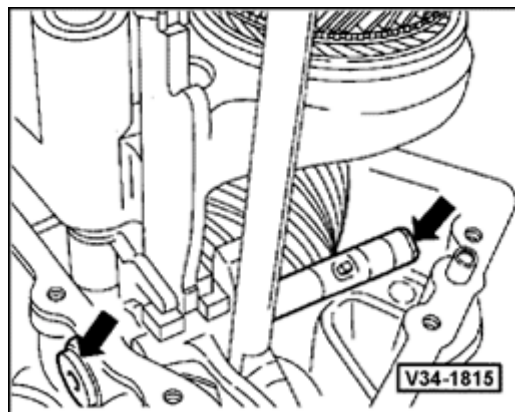

- A** - Remove relay shaft bolts (arrows).

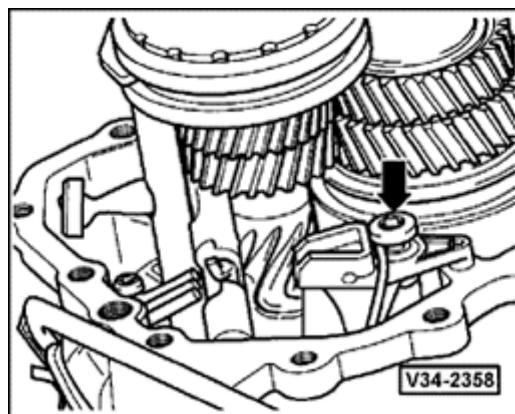

- A** - Unbolt shift detent (arrow) and swing out.

34-54

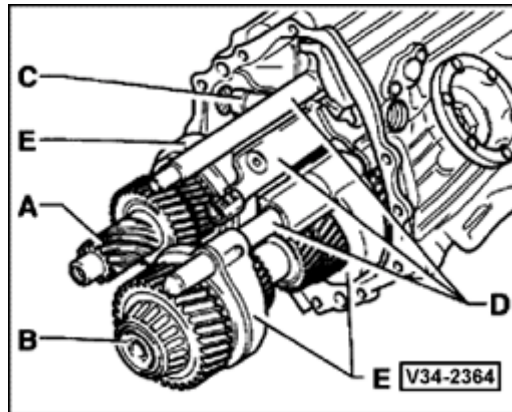

A

- Input shaft -A-, pinion shaft -B-, relay shaft -C-, selector rods -D- with shift rod and shift forks -E- must all be carefully pulled out together.

Installing

Note:

If the input shaft ball bearing, the input shaft or the transmission housing is replaced, it is necessary to re-determine the thickness of the circlips for the input shaft first ⇒ [Page 35-17](#) , input shaft adjusting.

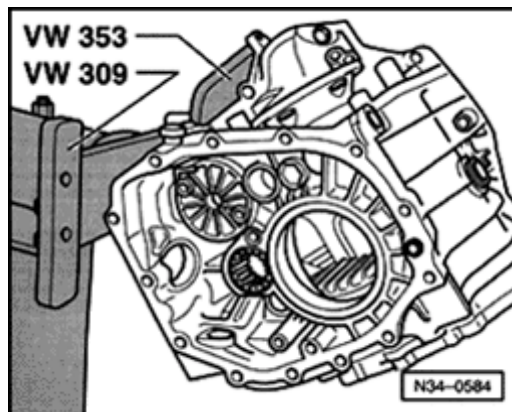

A

- For easier installation of following components, swing transmission housing into position shown.

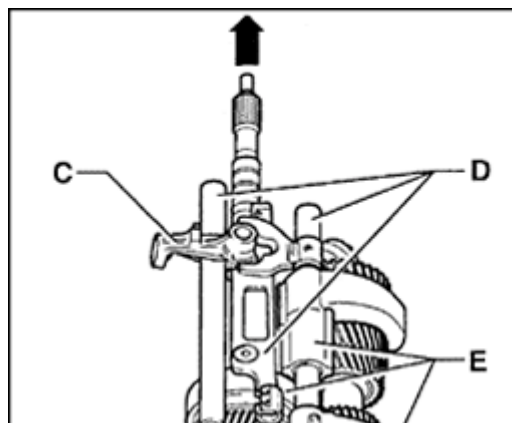

A

- Assemble input shaft -A-, pinion shaft -B-, relay shaft -C-, selector rods -D- with shift rod and selector forks -E-.
- Install these components into transmission housing as a set.

Note:

The relay shaft -C- and the shift rod can also be installed later if necessary ⇒ [Page 34-56](#) , Illustration V34-1816 and ⇒ [Page 34-57](#) , illustration V34-2120

34-56

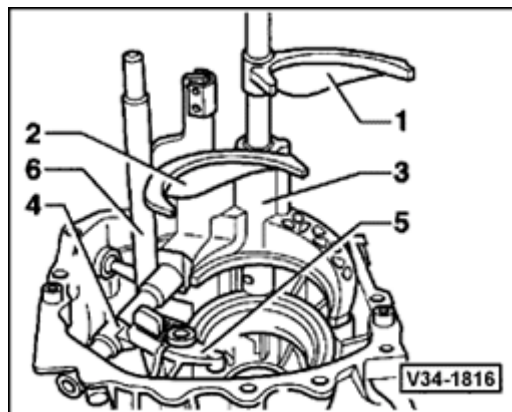

▲ Position of shift mechanism in transmission

- 1 - Shift fork 5th and reverse gears
- 2 - Shift fork 3rd and 4th gears
- 3 - Shift fork 1st and 2nd gears
- 4 - Relay shaft
- 5 - Shift detent
- 6 - Shift rod

Note:

Illustration is shown without the drive axle and pinion.

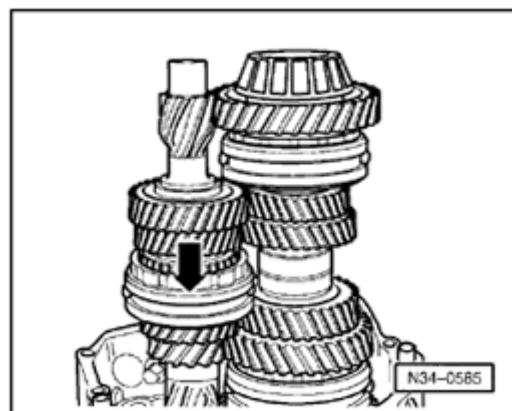

- ▲ - Move transmission housing and engage 3rd gear (direction of arrow).

34-57

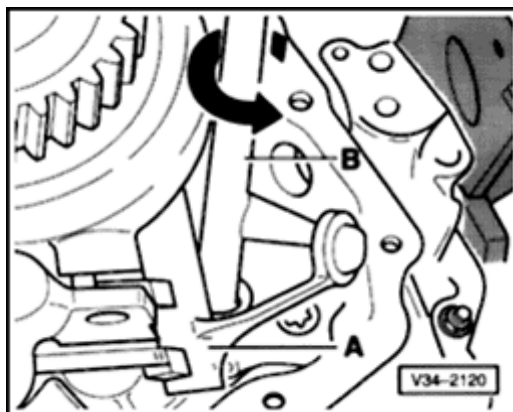

- A**
- Install relay shaft -A-.
 - Place inner shift rod -B- sideways into mounting hole in transmission housing and assemble into mounting eye.
 - Carefully turn shift rod in direction shown (arrow).

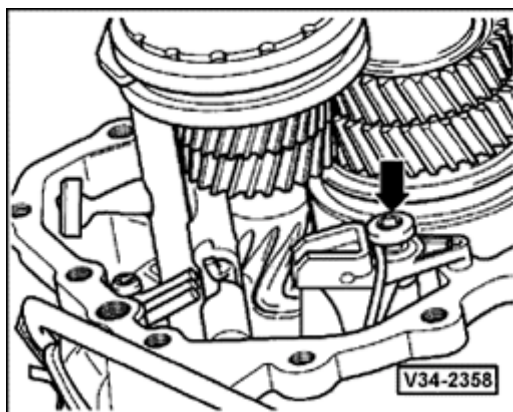

- A**
- Insert shift detent and tighten bolt (arrow) securely.

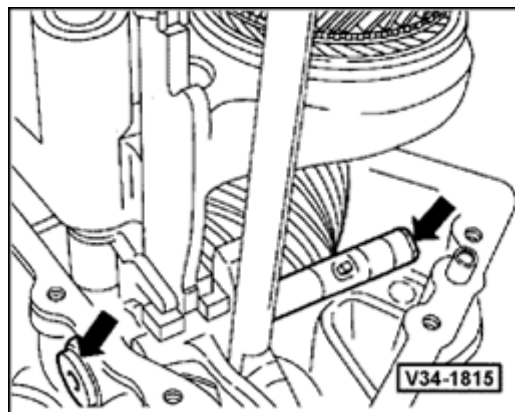

- A**
- Install relay shaft stop bolts (arrows).
 - Replace O-ring for multi-function switch.

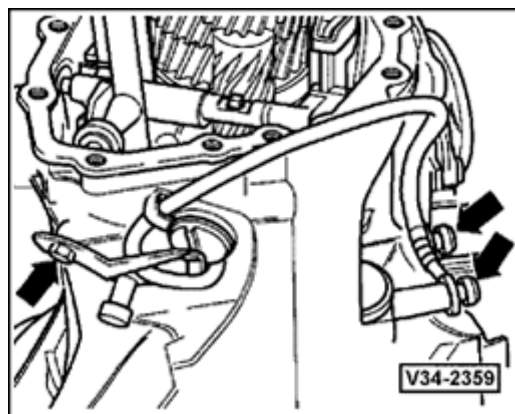

- A**
- Carefully insert multi-function switch and tighten (arrows).

34-59

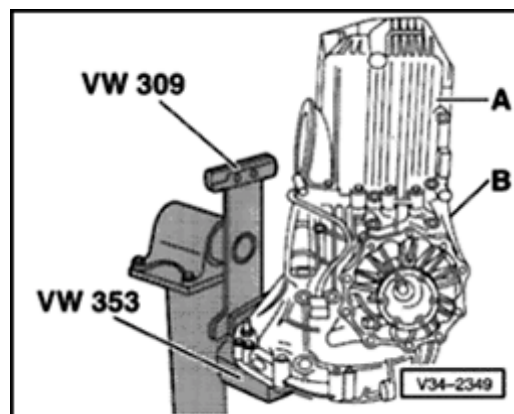

- A** Make sure dowel sleeves for transmission cover -A- are installed in transmission housing -B-.
- Coat sealing surfaces with a thin layer of sealant AMV 188 001 02.
 - Install transmission cover onto transmission housing.

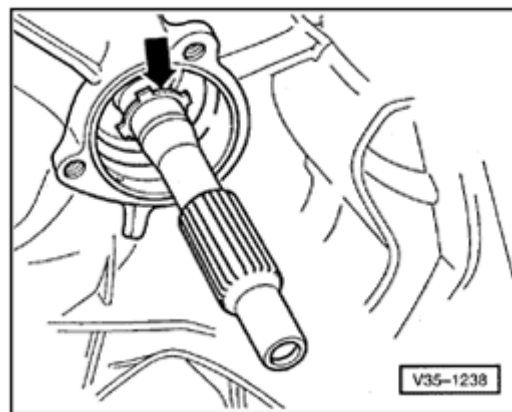

- A**
- Install rear circlip (arrow) for input shaft ball bearing.
 - Slide ball bearing onto input shaft.
- Installation position: closed side of ball cage faces toward transmission housing.

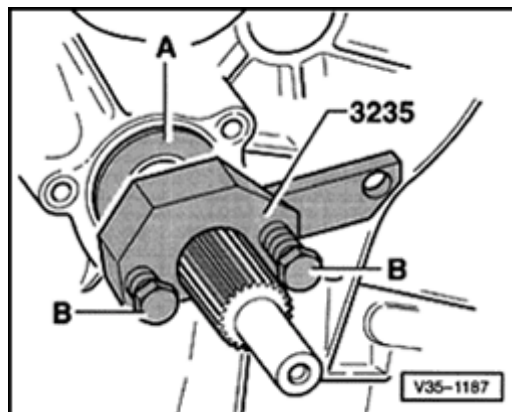

- A**
- Press in ball bearing.
 - Slide thrust piece -A- of press device onto input shaft.
 - Position press device behind splines for clutch plate.
 - Screw in bolts -B- and tighten slightly.
- The bolts bear against the indentations in thrust piece -A-.
- Press in ball bearing onto seat by alternately tightening bolts -B- (1/2-turn at a time) until stop is reached.

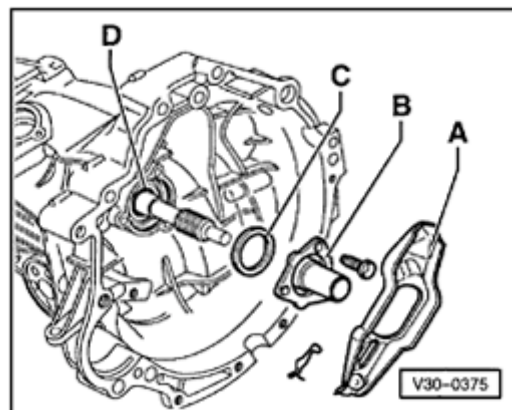

- A**
- Install front circlip -D- for input shaft ball bearing.
 - Install spring washer -C-.
- Position: convex side faces guide sleeve -B-.

Notes:

- ◆ *Before installing guide sleeve, cover splines on input shaft with a shrink tubing to protect the seal.*
- ◆ *Installing seal in guide sleeve ⇒ [Page 30-18](#) .*

34-61

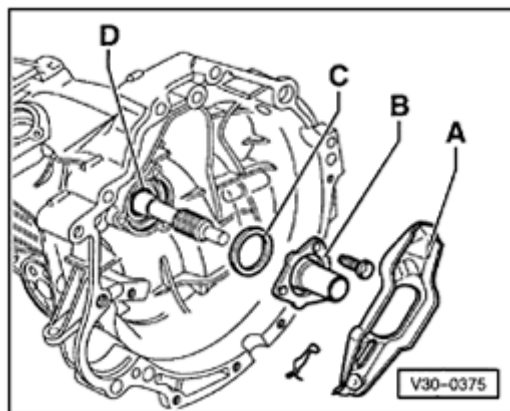

- A**
- Install guide sleeve -B- for throwout bearing.
 - Install clutch release lever -A- and throwout bearing.