

Manually adjustable steering column, removing and installing

Removing

The manually adjustable steering column is supplied as an assembly through the Parts Department. The steering column is serviced by replacement only.

The ignition lock from the faulty steering column can be refitted ⇒ [page 48-82](#) .

WARNING!

Before removing the steering wheel:

- ◆ ***The wheels must be in straight-ahead position before removing the steering wheel.***
- ◆ ***Observe all safety precautions before starting work on any part of the airbag system ⇒ [page 48-62](#) .***

Non compliance with the above can cause failure of the airbag system.

- Remove driver-side airbag unit ⇒ [page 48-64](#) (for sport steering wheel ⇒ [page 48-68](#)).

- Remove steering wheel ⇒ [page 48-67](#) (for sports steering wheel ⇒ [page 48-70](#)).

Removing steering column switch

- Release steering column adjuster.
- Pull steering column out fully (to end of adjustment range).

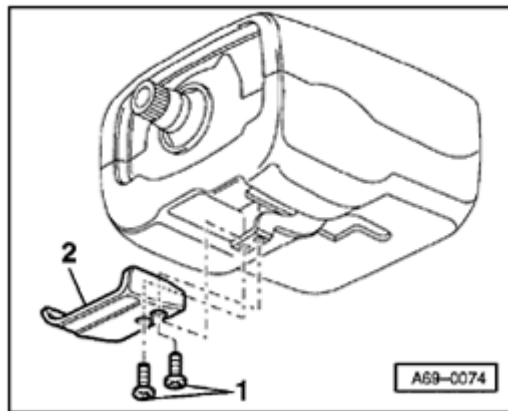

A

- Remove screws -1- (2x).
Tightening torque: 3 Nm (27 in. lb)
- Remove handle -2-.

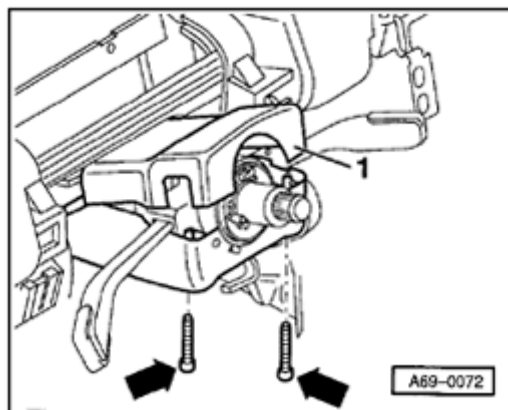

A

- Remove two screws (arrows).
Tightening torque: 0.6 Nm (5 in. lb)
 - Remove upper section of steering column switch trim -1-.
- When installing, insert upper section into hooks of lower section, swivel downward and install screws

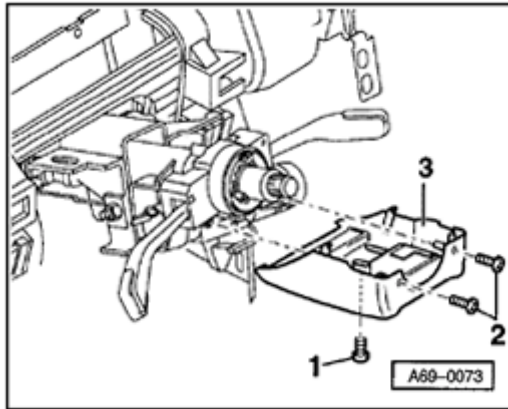
**A**

- Remove screws -2- (2x).
Tightening torque: 0.6 Nm (5 in. lb)
- Remove socket-head bolt -1-.
Tightening torque: 0.6 Nm (5 in. lb)
- Remove lower steering column switch trim -3-.

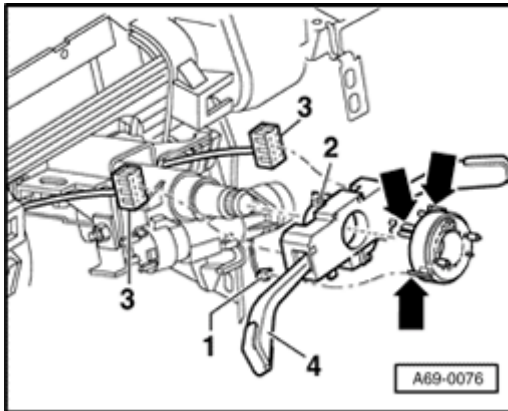
**A**

- Disconnect harness connector -1-.
- Remove screw -2-.
Tightening torque: 3 Nm (27 in. lb)
- Disconnect harness connectors -3-.
- Remove steering column switch -4-.

48-87

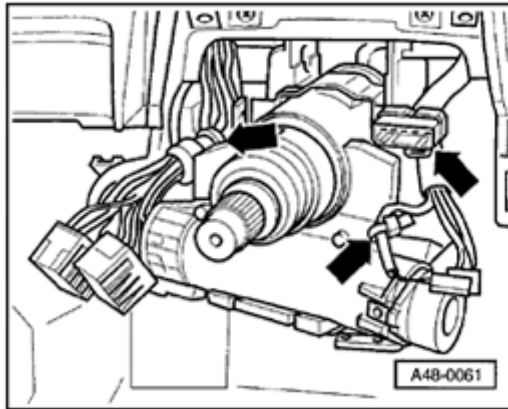

A

- Remove tie wraps and disconnect harness connectors on steering column.
- Lock cable must be disengaged on vehicles with automatic transmission
- Move selector lever to "P" position.

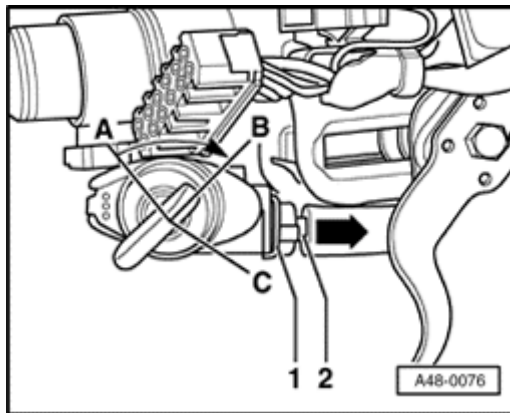

A

- Turn ignition key to position -B- (ignition ON).
- Lift locking clip -1- slightly and disconnect lock cable -2- from steering lock housing.

48-88

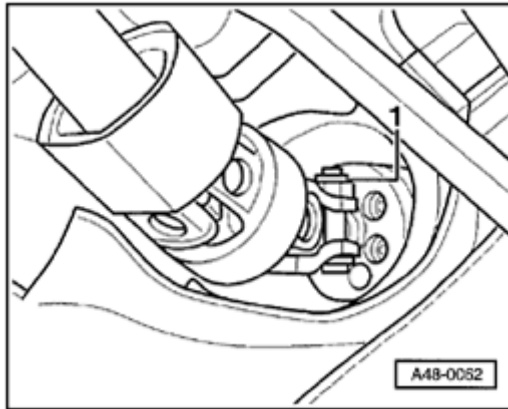

- A**
- Remove nut -1- on universal joint.
 - Disengage by turning eccentric bolt (Torx[®] T50) clockwise and remove bolt.
 - Release steering column adjuster.

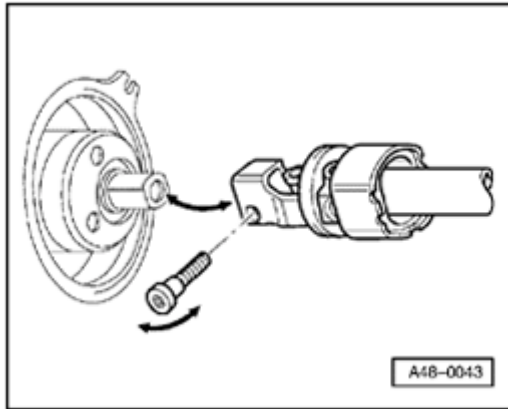

- A**
- Swing universal joint clear.

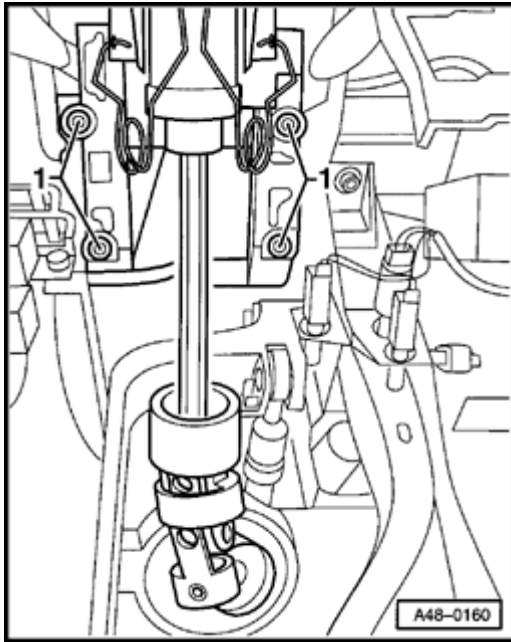

A

- Remove steering column socket-head bolts -1- and remove steering column.
- ◆ Removing and installing steering lock housing ⇒ [page 48-95](#)
- ◆ Checking steering column for damage ⇒ [page 48-94](#)
- ◆ Removing and installing lock cylinder:
⇒ [Repair Manual, Electrical Equipment, Repair Group 94](#)

48-90

Installing

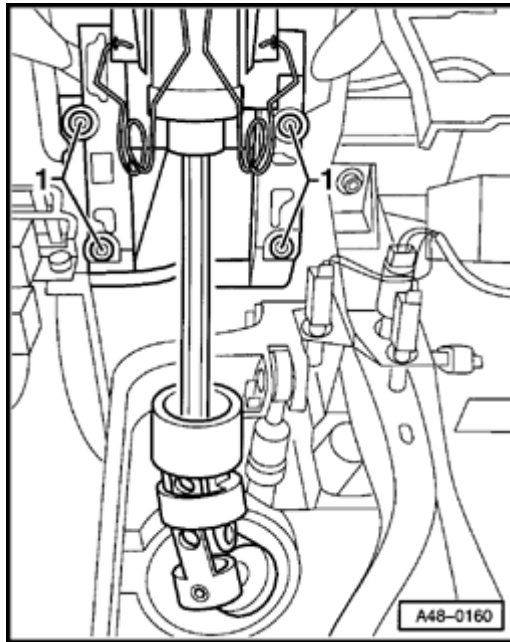

A

- Attach steering column to cross member by installing four socket-head bolts -1-.
- Release steering column adjuster.
- Install universal joint onto steering gear pinion.

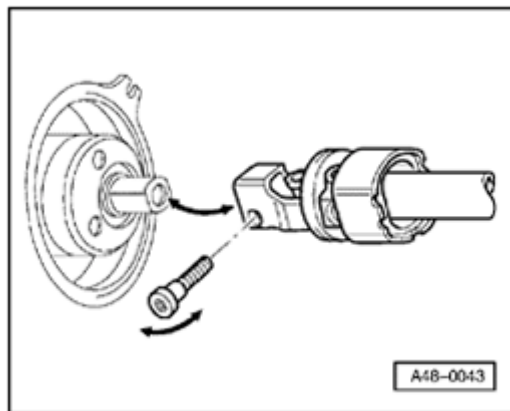

A

- Install eccentric bolt (Torx® T50) through lower part and tighten (engage) counterclockwise.
 - Install nut and tighten.
- Tightening torque: 30 Nm (22 ft lb)

48-91

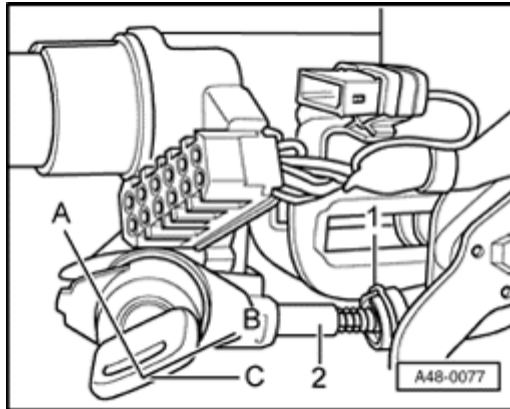

- On vehicles with automatic transmission, lock cable must be engaged

A

- To engage lock cable, first turn ignition key to position -B- (ignition ON).
- Move selector lever to park position.
- Install lock cable -2- in steering lock housing. Make sure locking clip -1- engages.

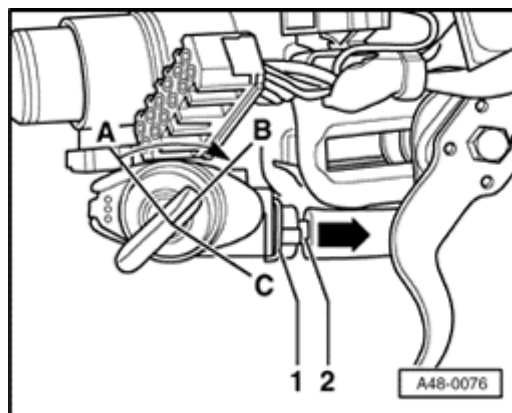

Functional check for lock cable

A

- Turn ignition key to position -B- (ignition ON).
 - ◆ It must be possible to move selector lever from park position without any resistance
 - ◆ It must only be possible to remove ignition key when selector lever is in park position and ignition key is in OFF position -A-
- Move selector lever to park position.
 - ◆ Ignition lock must operate freely
 - ◆ With ignition key in position -A- (ignition OFF) it should not be possible to move selector lever from park position. Ignition key can be removed

Basic adjustment and routing of lock cable:

⇒ [Repair Manual, 5 Spd. Automatic Transmission 01V, Repair Group 37](#)

Installing, continued for all vehicles

- Install steering column switches with trim.
- Align steering column so that gaps in trim are even.

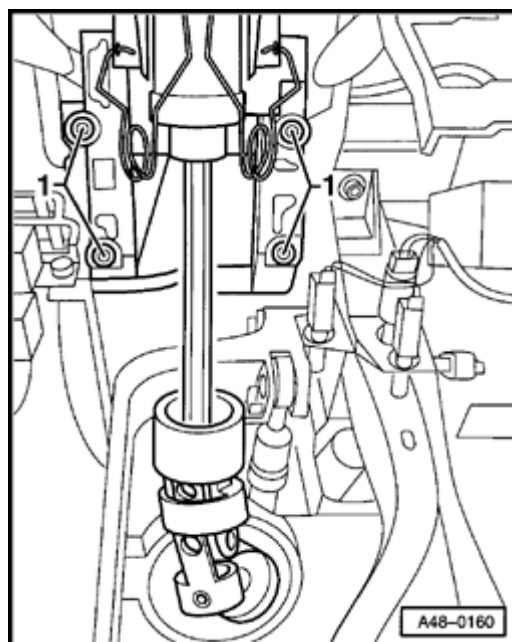

A

- Tighten socket-head bolts -1- on steering column.
Tightening torque: 22.5 Nm (17 ft lb)
- Install driver's side storage compartment.
- Install steering wheel ⇒ [page 48-67](#) (for sports steering wheel ⇒ [page 48-70](#)).
- Install driver-side airbag unit ⇒ [page 48-64](#) (for sport steering wheel ⇒ [page 48-68](#)).

Steering column, checking for damage

Determining if steering column must be replaced following an accident:

Visual check

- Check all steering column components for damage.

Functional check

- Make sure steering column turns easily without jerking.
- Make sure steering column can be adjusted for height and reach.

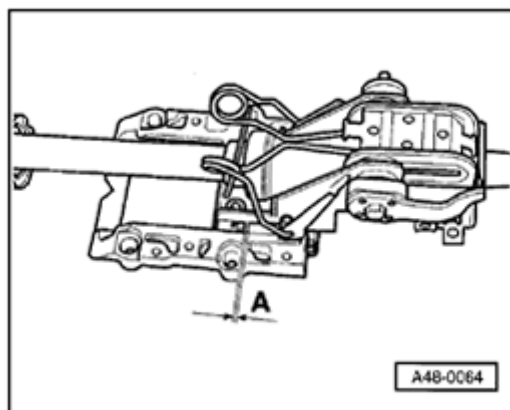

A

- Check gap (dimension -A-) between slide and mounting bracket.
 - If dimension -A- is larger than 0.5 mm (0.20 in.), steering column is damaged and must be replaced

Steering lock housing, removing and installing

Removing

WARNING!

- ◆ **Before removing the steering column, make sure the wheels are in the straight-ahead position.**
- ◆ **Observe the safety precautions for working on airbags ⇒ [page 48-62](#) .**

Non compliance with the above can cause failure of the airbag system.

- Remove driver-side airbag unit ⇒ [page 48-64](#) (for sport steering wheel ⇒ [page 48-68](#)).
- Remove steering wheel ⇒ [page 48-67](#) (for sports steering wheel ⇒ [page 48-70](#)).
- Remove steering column switch ⇒ [page 48-85](#) .
- On vehicles with automatic transmission, disengage lock cable ⇒ [page 48-85](#) .

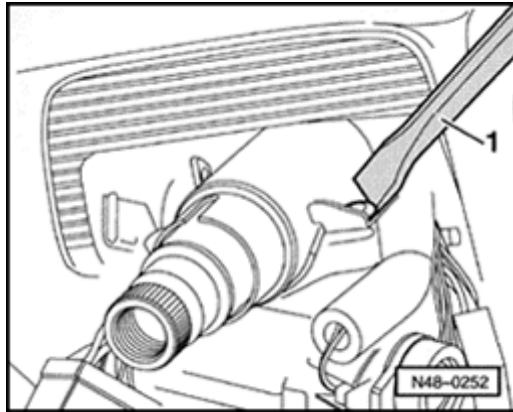

A

- Drill out or chisel off shear bolts using suitable chisel -1-.

Removing and installing lock cylinder:

⇒ [Repair Manual, Electrical Equipment, Repair Group 94](#)

Installing

- Install new shear bolts.
- Tighten shear bolts until heads shear off.
- On vehicles with automatic transmission, engage lock cable ⇒ [page 48-90](#) .
- Check function of lock cable ⇒ [page 48-92](#) .
- Install steering column switch.
- Install steering wheel ⇒ [page 48-67](#) (for sports steering wheel ⇒ [page 48-70](#)).
- Install driver-side airbag unit ⇒ [page 48-64](#) (for sport steering wheel ⇒ [page 48-68](#)).