

42-77

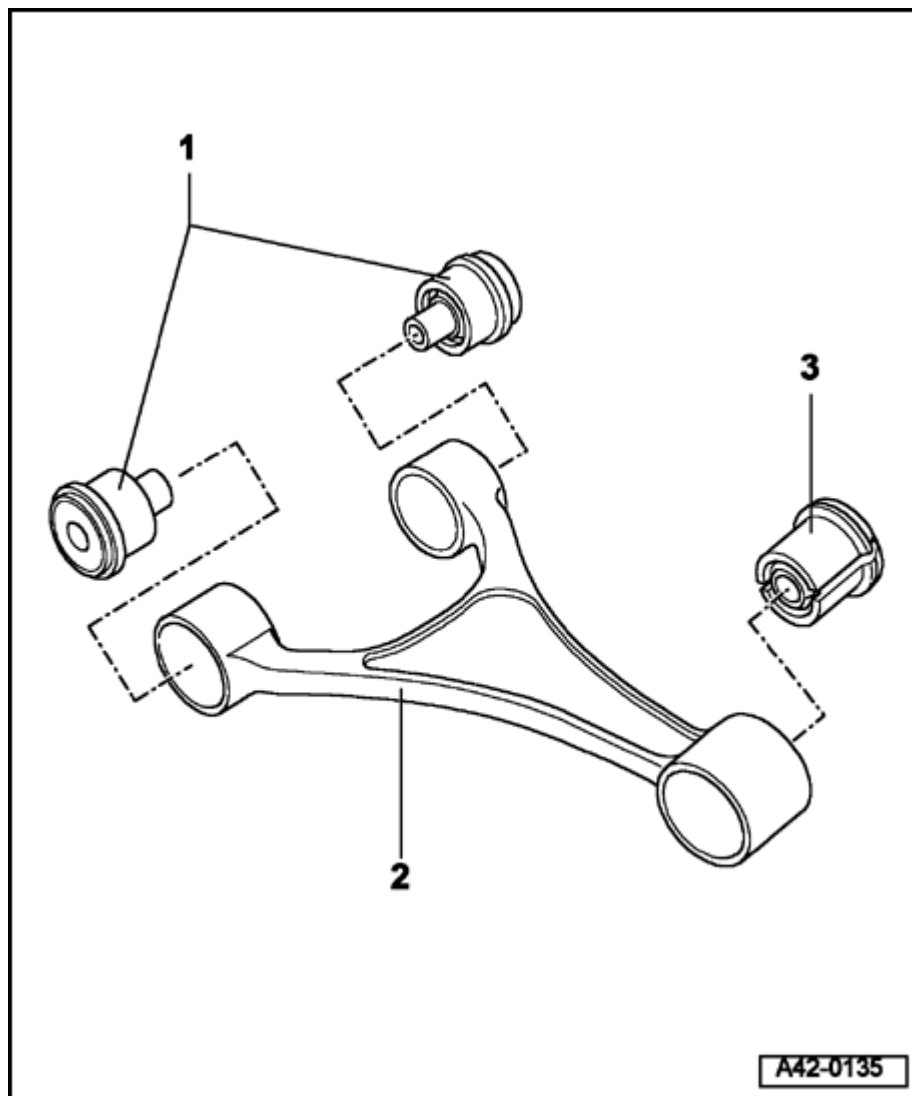

Upper control arm

Forged upper control arm, servicing

1 - Bonded rubber bushings

- ◆ Pressing out ⇒ [Figs. 1](#) and ⇒ [2](#)
- ◆ Pressing in ⇒ [Fig. 4](#)

2 - Upper control arm

- ◆ Replacement part has bonded rubber bushings installed
- ◆ Left and right-sides are identical

3 - Bonded rubber bushing

- ◆ Pressing out ⇒ [Fig. 3](#)
- ◆ Pressing in ⇒ [Fig. 5](#)
- ◆ Bushing can be installed with slit in outer cover in any installed position

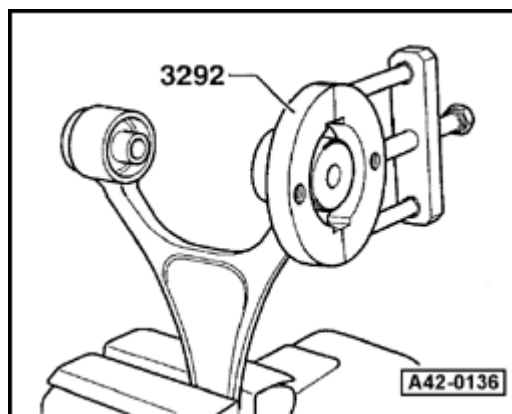

A **Fig. 1 Attaching assembly device to control arm**

Be careful not to damage the surface of the control arm

- Attach 3292 assembly device with both sides of tool jaws between bearing and control arm.
- Screw in spindle up to stop so that tool compresses rubber metal bushing against eye in control arm eye.

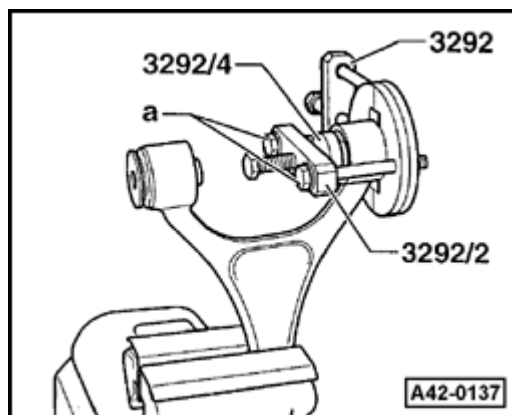

A **Fig. 2 Attaching pressure piece to control arm and pressing out bonded rubber bushing**

- Secure 3292/2 to 3292 using bolts -a- (M10 x 80).
- Attach 3292/4
- Screw spindle into 3292 until bonded rubber bushing is pressed out.

42-79

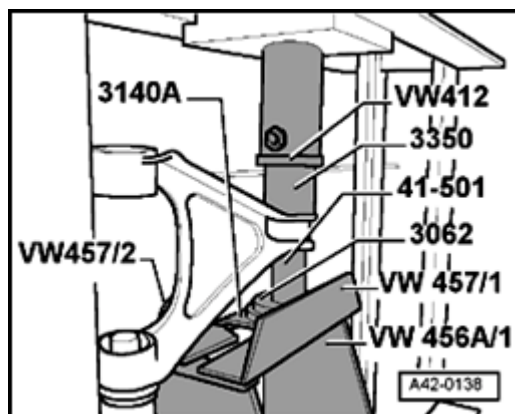

A Fig. 3 Pressing bonded rubber bushing out from control arm

Note:

Make sure to install 41-501 lower pipe piece exactly correct.

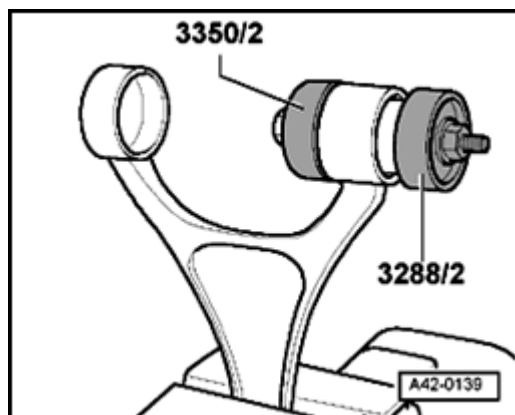

A Fig. 4 Pressing bonded rubber bushing into control arm

- Install bonded rubber bushing at right angle to control arm.
- Install 3288/2 and 3350/2 pressure pieces as shown together with bolts and press in bushing up to stop in control arm eye.

42-80

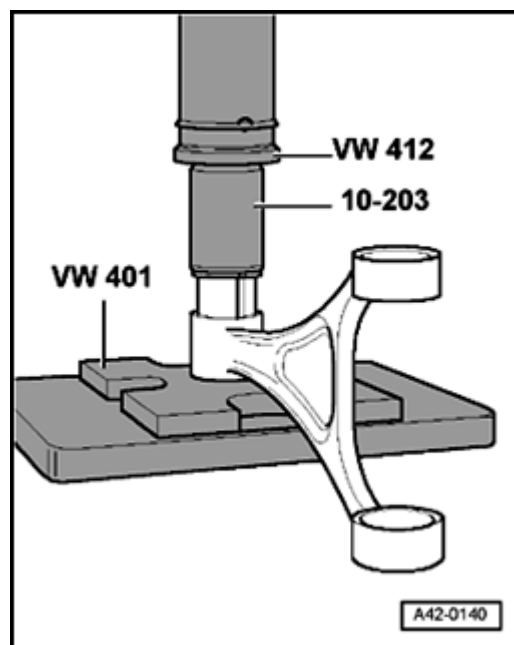

A

Fig. 5 Pressing bonded rubber bushing into control arm

- Press in bushing up to stop.

42-81

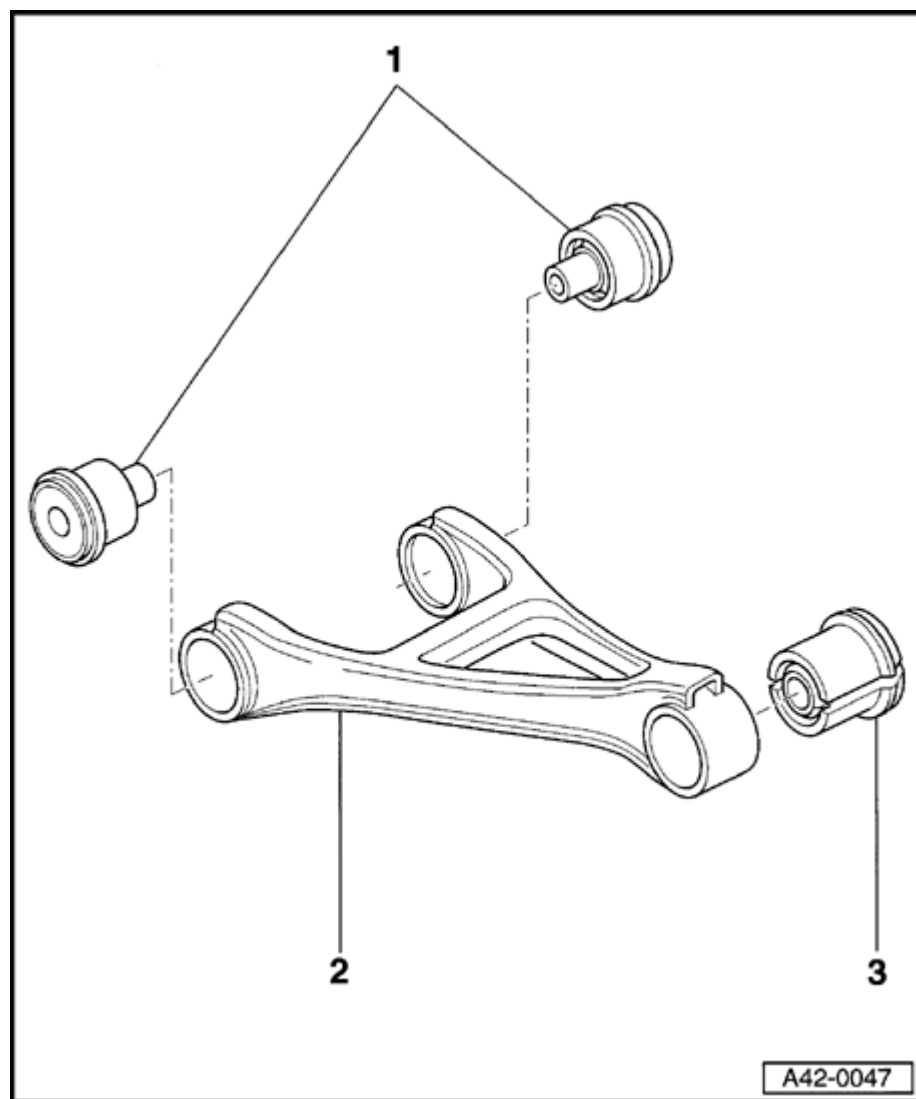

Sheet steel upper control arm, servicing

1 - Bonded rubber bushings

- ◆ Pressing out ⇒ [Fig. 1](#)
- ◆ Pressing in ⇒ [Fig. 3](#)

2 - Upper control arm

- ◆ Replacement part supplied with bonded rubber bushings installed
- ◆ Left and right-side components are identical

3 - Bonded rubber bushing

- ◆ Pressing out ⇒ [Fig. 2](#)
- ◆ Pressing in ⇒ [Fig. 4](#)
- ◆ Bushing may be installed with slots in bushing aligned in any direction

42-82

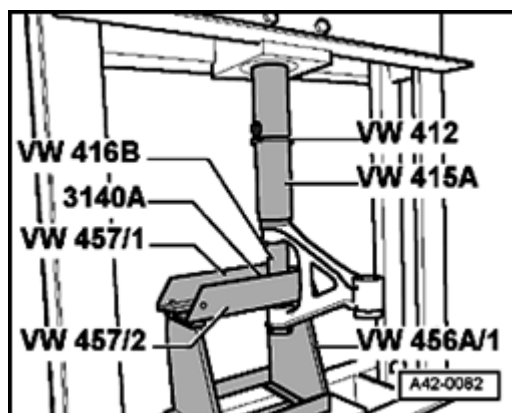

A

Fig. 1 Pressing bonded rubber bushings out of upper control arm

If VW416B tube, 37 mm dia. becomes canted while pressing out, relieve pressure and start over.

CAUTION!

Be careful not to damage the surface of the upper control arm.

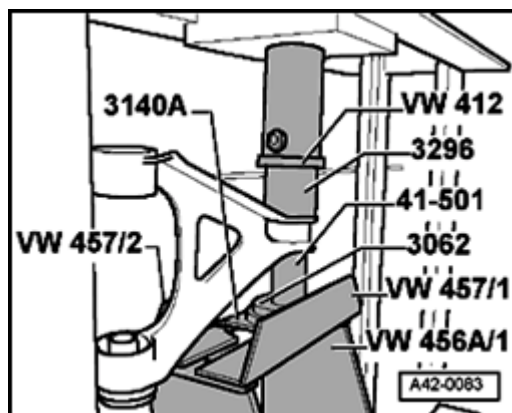

A

Fig. 2 Pressing bonded rubber bushing out of upper control arm

Note:

41-501 tubular section must be exactly in the correct position.

42-83

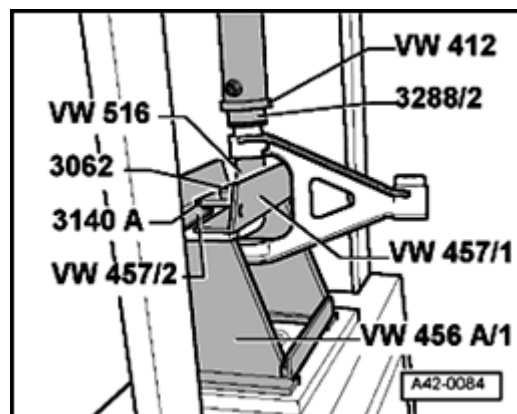

A

Fig. 3 Pressing bonded rubber bushings into upper control arm

- Position bonded rubber bushing perpendicular to upper control arm.
- Press bushing fully in up to stop.

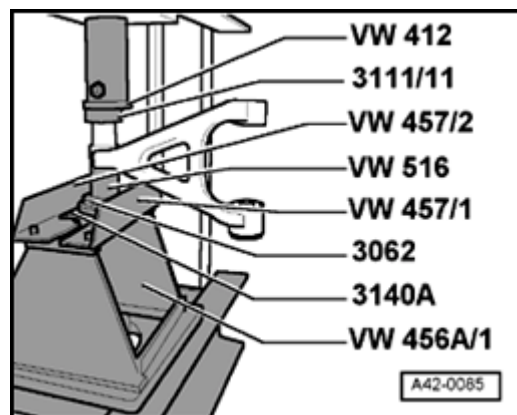

A

Fig. 4 Pressing bonded rubber bushing into upper control arm

- Press bushing fully in up to stop.