

40-11

Running change from connecting link with ball joint to connecting link with rubber bushing (m.y. 1999 ➤)

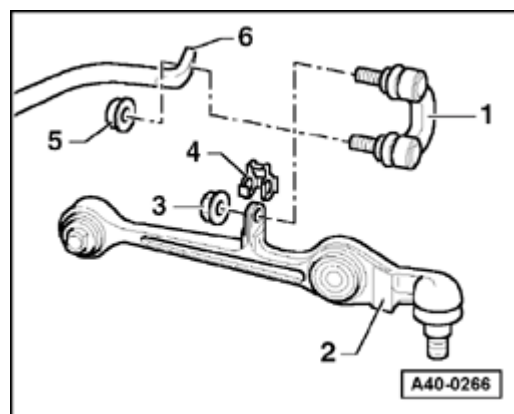

Connecting link with ball joint

1 - Connecting link with ball joint

2 - Lower track control link

3 - Self-locking hex nut

40 Nm (30 ft lb) + 90°

4 - Clip

5 - Self-locking nut

100 Nm (74 ft lb)

6 - Stabilizer bar

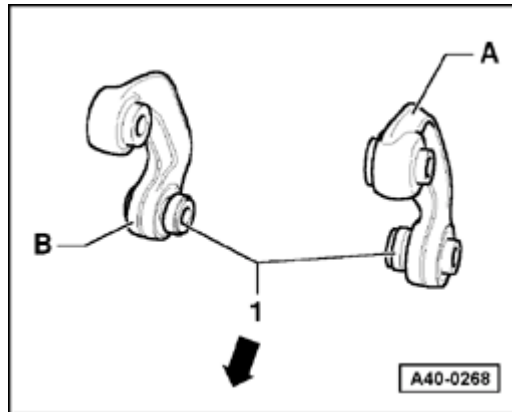

Connecting link with rubber bushing



Connecting link -A- for left side of vehicle.

- ◆ Arrow on connecting link points in direction of travel

Permanently installed spacer -1- at connecting link must be installed at stabilizer bar.

Connecting link -B- for right side of vehicle.

- ◆ Arrow on connecting link points in direction of travel
- ◆ Arrow points in direction of travel

40-13

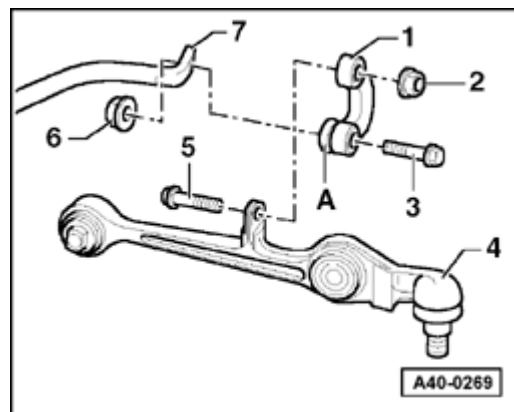

Bonded rubber bushings can only be turned a limited amount. Therefore only tighten bolted connections at the suspension links when the vehicle is standing on the ground.

1 - Connecting link with rubber bushing

2 - Self-locking hex nut

40 Nm + 90°

3 - Hex bolt

4 - Lower track control link

5 - Hex bolt

6 - Self-locking hex nut

40 Nm (30 ft lb) + 90°

7 - Stabilizer bar

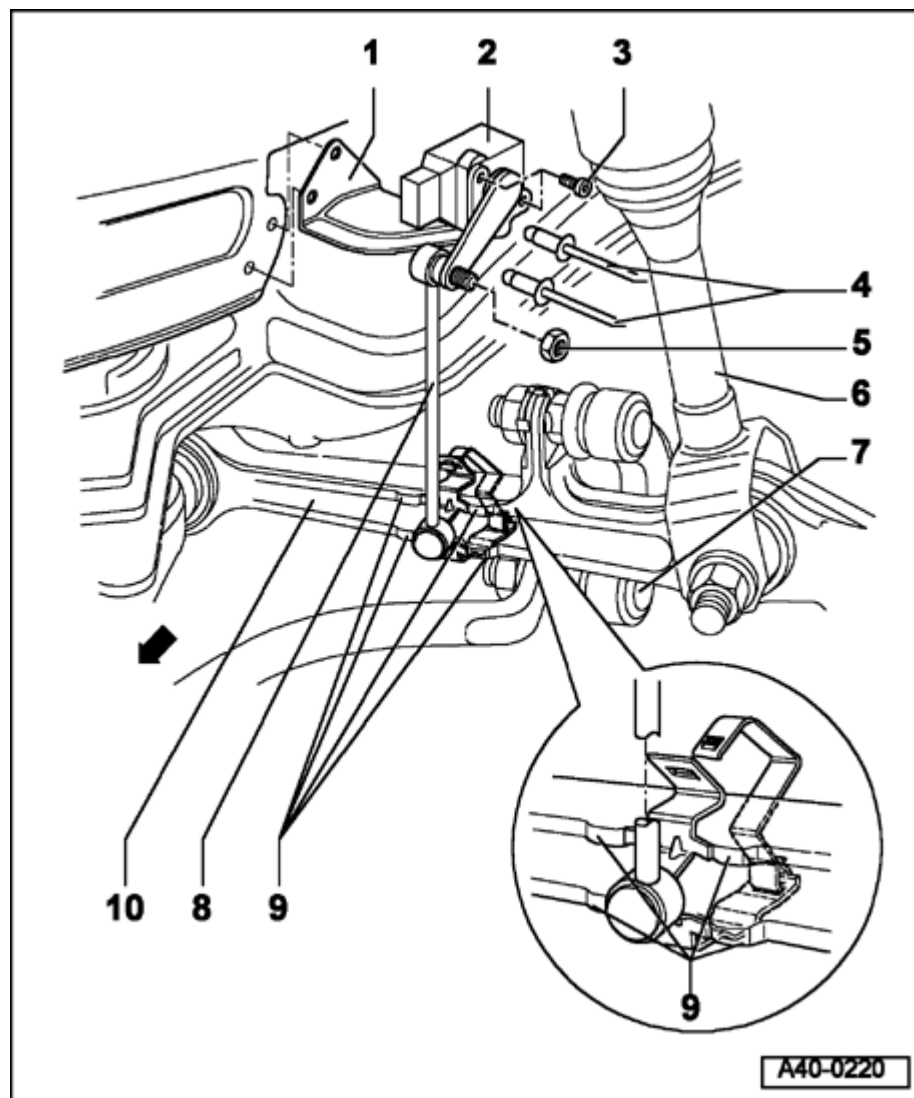

Headlight range adjuster, removing and installing

Through m.y. 1998 on vehicles with xenon headlights, a headlight range adjuster may be installed in the left headlight.

Arrow points in direction of travel.

1 - Mounting plate

2 - Level sensor

3 - Bolts

◆ 4 Nm +1/-0 Nm (35 in. lb +9/-0 in. lb)

4 - Pop rivets (2x steel)

◆ 4.8 mm diameter

5 - Nut

◆ 3 Nm +1/-0 Nm (27 in. lb +9/-0 in. lb)

◆ ⇒ [Note, page 40-16](#)

6 - Shock absorber

7 - Connecting link

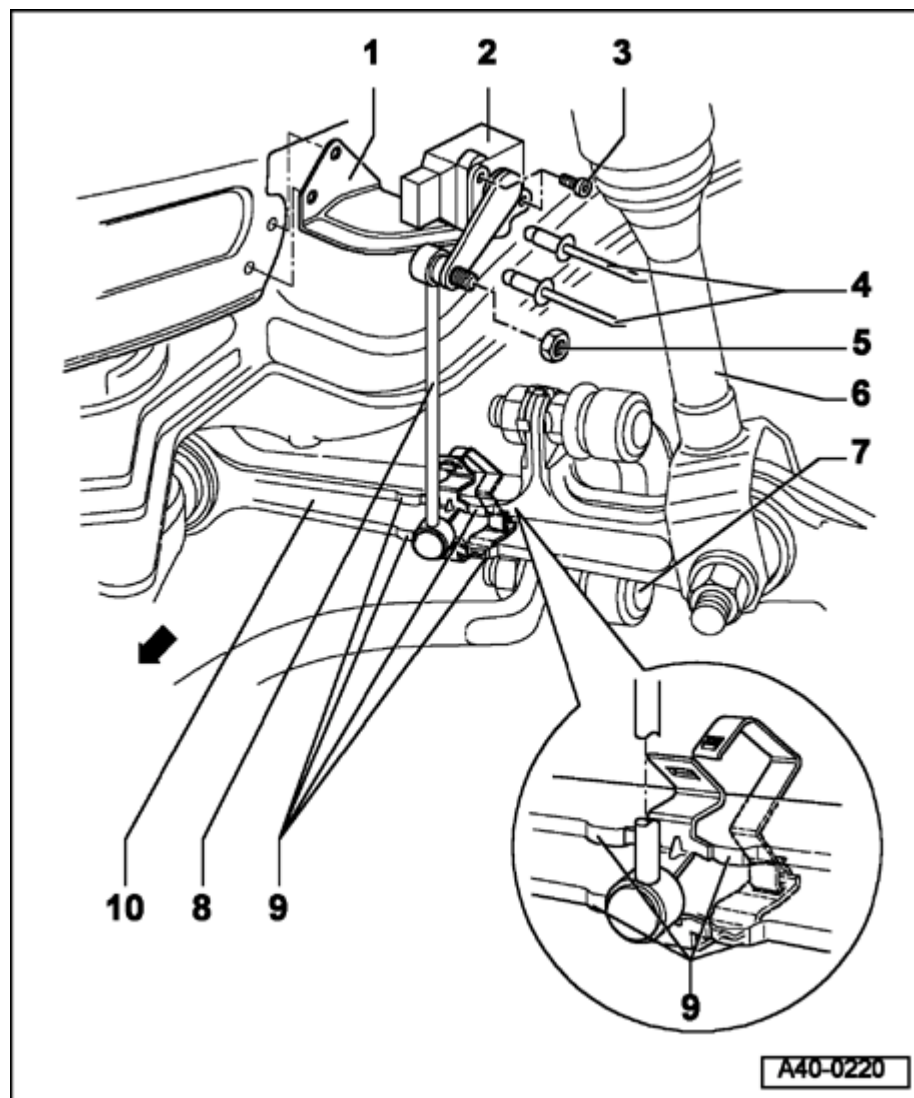

8 - Rod for headlight range adjuster

9 - Protrusions

◆ Position clamp between two protrusions

10 - Lower track control link

When removing and installing the lower track control link, the clamp must be removed

Note:

Attach the rod for headlight range adjuster to the level sensor, using a 10 mm open end wrench no thicker than dimension -A- to prevent damaging the seal.

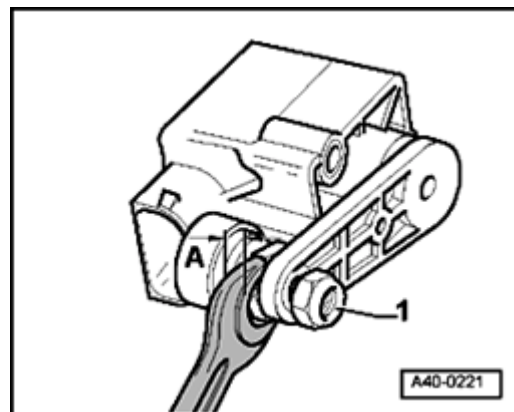

A

- ◆ Dimension -A-: 4 mm (0.157 in.)
- ◆ Nut -1- tightening torque: 3 Nm +1/-0 Nm (27 in. lb +9/-0 in. lb)
- Using pliers, secure rod for headlight range adjuster to lower track control link between two protrusions

When installing the headlight range adjuster, make sure that the arm for the level sensor and the rod for the headlight range adjuster are correctly aligned to each other.

Notes:

- ◆ *Rod for headlight range adjuster must be vertical.*
- ◆ *Level sensor arm must point downward and forward.*