

Central locking system (Avant), repairing

Assembly overview

1 - Pressure and vacuum lines

2 - Right-front door actuator valve

- ◆ Removing and installing ⇒ [page 57-12](#)

3 - Vacuum line connectors

- ◆ Disconnect vacuum line connectors ⇒ [page 57-42](#)

4 - Right-rear door actuator valve

- ◆ Removing and installing ⇒ [page 58-14](#)

5 - Fuel filling flap lock actuator

- ◆ Removing and installing ⇒ [page 57-52](#)

6 - Central locking system pump

- ◆ Removing and installing ⇒ [page 57-56](#)

7 - Rear lid lock actuator

- ◆ Removing and installing ⇒ [page 57-53](#)

57-51

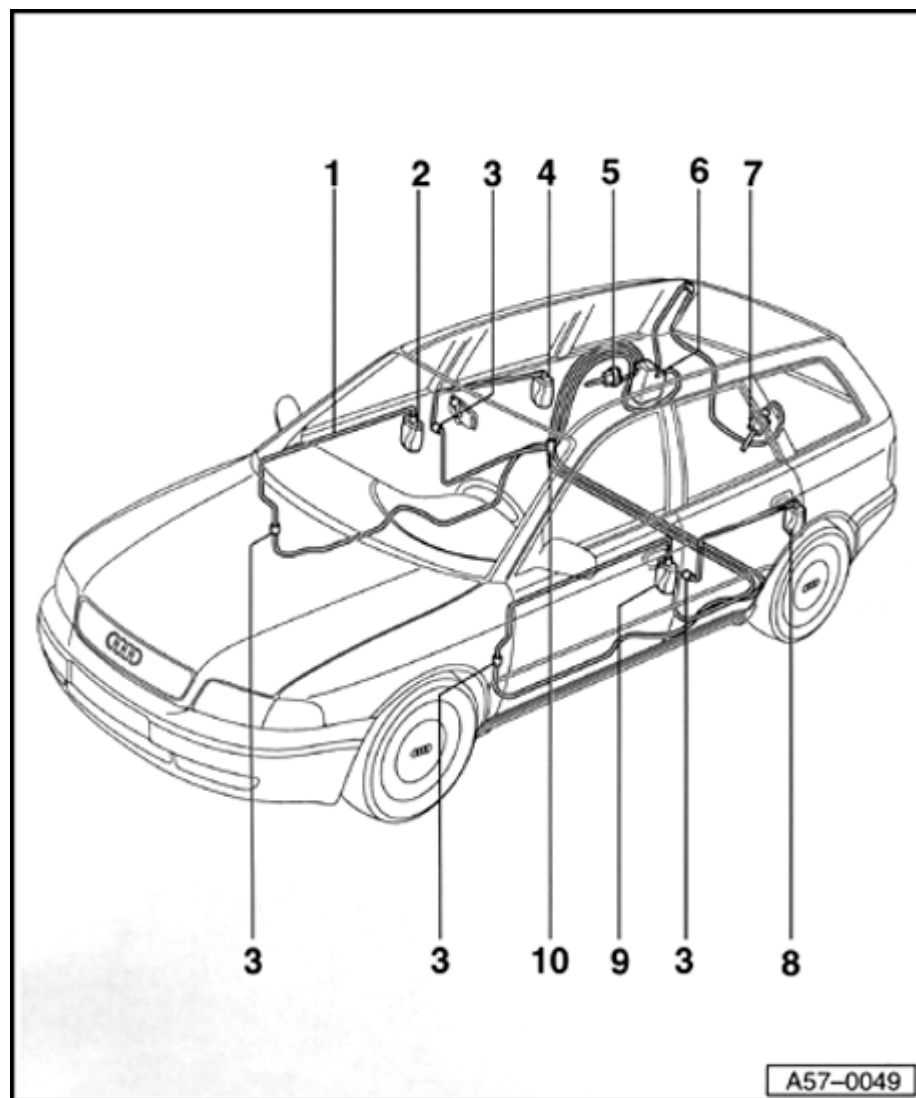
**8 - Left-rear door actuator valve**

- ◆ Removing and installing same as for right door

9 - Left-front door lock actuator

- ◆ Removing and installing same as for right door

10 - Distribution box

- ◆ Connected with all other vacuum lines, excluding lines for rear lid

Fuel filling flap lock actuator, removing and installing

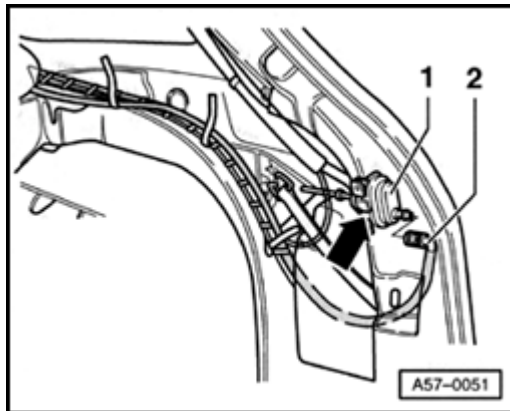
**A**

- Disengage locking mechanism from angled plug and detach vacuum line -2- from lock actuator -1-.
- To remove, press in locking lug (arrow) and pull lock actuator -1- rearward and out.
- To install, push into case until snap indicates engagement.

Rear lid lock actuator, removing and installing

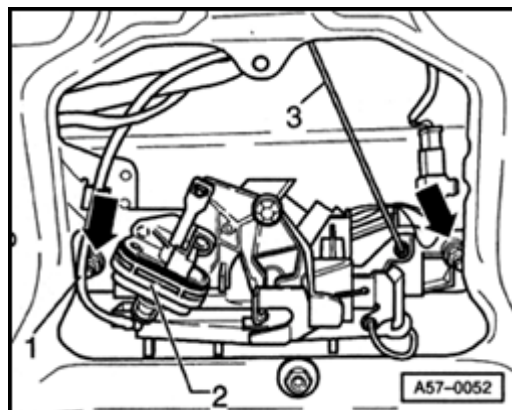

A

- Remove tailgate trim ⇒ [page 57-54](#) .
- Disengage lock system at plug for vacuum line -1- and remove from lock actuator -2-.

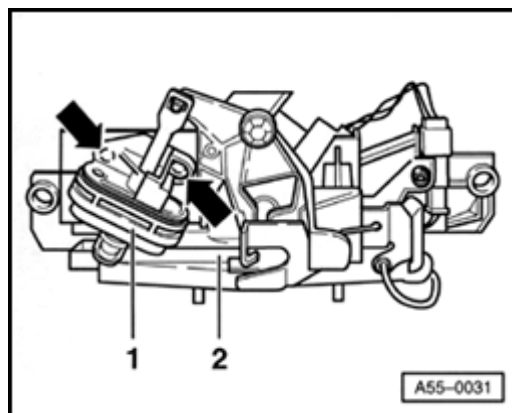

A

- Press clamping pins (arrow) out and remove lock actuator -1- from lock -2-.
- Clamping pins must be snapped back into expanding clips during installation.
- Pry out using screwdriver if necessary.

Note:

Illustration shows component after removal.

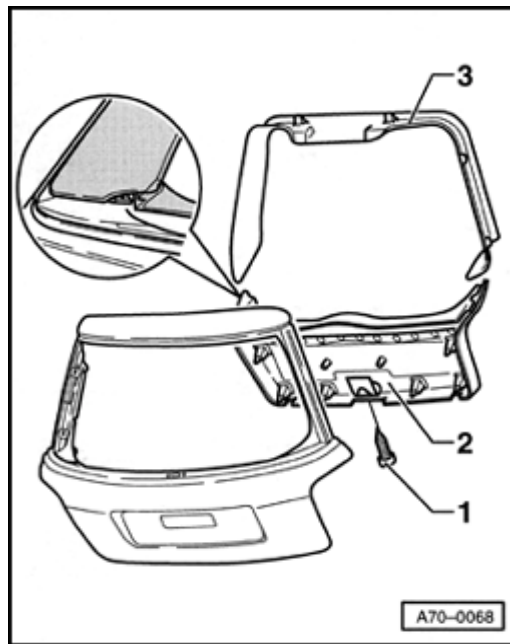

A

Fig. 1 Removing and installing tailgate trim

- Remove bolt -1- from handle well.
Torque: 1.5 Nm + 0.5 Nm (13 in. lb + 4 in. lb)
- Unclip lower rear hatch trim -2-.
- Unclip upper rear hatch trim -3-.

Note:

When installing the lower trim, guide bars must be inserted in upper trim.

57-55

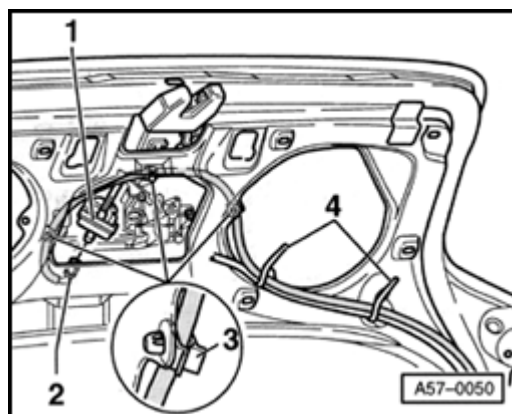

A

Fig. 2 Line routing

- Route pressure and vacuum lines through tie wraps -4- as shown in diagram and snap into clips -3-.
- Snap harness connector -2- into lock actuator.

Central locking system pump, removing and installing

- Remove cover on side trim panel.
- A** - Unhook tension strap -1- at arrow -A-.
- Remove insulation -4- with pump for central locking system -2- from side panel.
- Fold back insulation and remove pump.
- Disengage vacuum line connectors and detach angled plug (arrow B-).

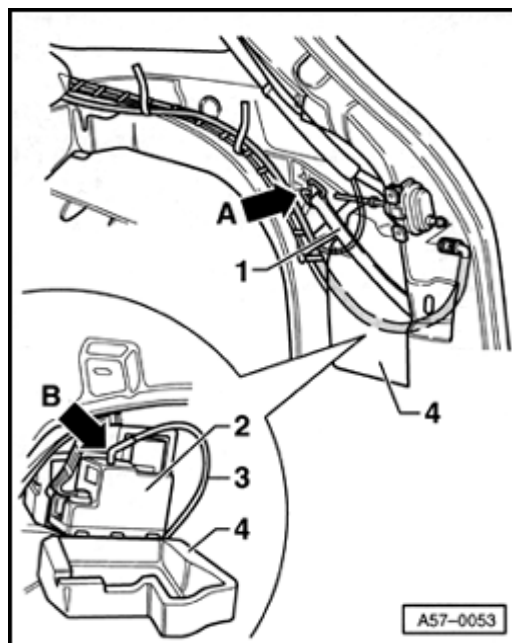

CAUTION!

After disconnecting all three vacuum line connectors from the central locking system pump, ensure that the middle 6-pin harness connector (power supply) is always plugged in last.